



National Historic

Preservation Month



WASHINGTON STATE
**HISTORIC
PRESERVATION
MONTH**

State Historic Preservation Officer

Award Ceremony – May 15, 2018



Clark County Historic Preservation Commission

Clark County



PRESERVATION EDUCATION
Award



Clark County Historic Preservation Program

Board of County Councilors Work Session



Robert Hinds, Chair, HPC, Sarah Fox, Vice-Chair and Jacqui Kamp, Planner III

Sept. 27, 2017

PRESERVATION EDUCATION AWARD

Clark County Historic Pres. Commission

Outreach - Historic Clark County Mobile App

Historic Clark County Mobile App!



NOW AVAILABLE



Want to know the story behind that old building in your neighborhood or near your work?

Download the free Historic Clark County app that puts that history right at your fingertips. Locate historic buildings and sites near you, anywhere in the county and share the info and your experience through social media.



historicpreservation@clark.wa.gov
clark.wa.gov/planning/historic



Outreach – Interpretive Panels

Clark County Courthouse

The Clark County Courthouse opened Nov. 29, 1941. Although it was not the county's first courthouse, it has endured longer than the previous three.

Local architect Day Walter Hilborn designed the six-story building in the Art Deco/Art Moderne style popular for public construction projects at the time. The structure showcased the most modern developments in the building arts.

The courthouse was built of reinforced concrete to prevent fire from destroying thousands of irreplaceable documents and records, which is what happened when the county's second courthouse burned in 1890.

The courthouse originally housed all county departments, a Justice of the Peace, other agencies and a 70-inmate jail. The one windowless courtroom included separate rooms for male and female jurors.

The building now houses only Clark County Superior Court and District Court courtrooms and offices.

In 2014, it was placed on the National Register of Historic Places for its significance as the headquarters of county-level government and politics, and, architecturally, as an excellent example of an Art Deco/Art Moderne-style public building.



The First Three Courthouses



Clark County's first courthouse was a two-story, wood frame structure built in 1855 on West Reserve Street, near Fort Vancouver.
Cost: \$1,000
CCJM Collection 01006



The second courthouse was a three-story brick building that stood in approximately the same location as today's courthouse. Built in late 1883, it went up in flames 7 1/2 years later, destroying a large number of public records.
Cost: \$44,460
CCJM Collection 01023



The third courthouse was a Romanesque style, three-story brick building with a large clock tower. Built in 1892, it stood slightly to the south of today's courthouse. The county outgrew it by the late 1930s, and it was replaced by the current courthouse and demolished. Cost: \$65,000
CCJM Collection 01037

The Architect

Few people had a greater impact on southwest Washington's built environment than architect Day Walter Hilborn.

He designed many well-known downtown buildings, including the Kiggins Theatre on Main Street, the original building for *The Columbian* newspaper on Evergreen Boulevard and the homes of many of Vancouver's social, political and business elite.

The courthouse is perhaps Hilborn's greatest legacy. It assured his place in local history and brought him nationwide recognition.



The Buckskin Brigade

Architect Day Walter Hilborn also designed the original Buckskin Brigade sculpture above the front entrance of the courthouse.

Executed by architectural sculptor Vic Schneider, the bas-relief work was poured as part of the wall. It depicts an Ironsides man with two fur trappers and symbolizes the role the fur trade played establishing Clark County as a center of government and business.

In 1978, workers preparing to paint the building noticed the sculpture was damaged, and it was taken down. Local citizens raised money to recreate the sculpture in bronze, and it was installed on Sept. 13, 1990.

Discover the history all



2016 Interpretive panel



Robert Hinds, Chair, HPC, Sarah Fox, Vice-Chair, HPC, and Jacqui Kamp, Planner III



COLUMBIAN BUILDING

The property consists of two distinct structures built as a single unit on one tax parcel in 1928. One building housed the *Columbian* newspaper from 1928 to 1955. The other building was retail space first occupied by a business named Storm King Ice Cream and followed by several other retail spaces.

The original *Columbian* Building was an "L" shaped building located at the corner of Evergreen and Broadway. The north side is described as restrained Beaux-Arts. The three bays separated by pilasters. The building facade has five bays. The Evergreen facade bay located in the middle three bays. Originally, the entrance is located in the central bay. The facade of both buildings was covered and made to appear as one building.

Water Day Hilborn, known as Day W. Hilborn, built the *Columbian* Building. Day Hilborn left a lasting architectural legacy in the state of Washington.

The *Columbian* newspaper
On October 10, 1890 local printer Tom Campbell published the first issue of the *Columbian*. Democratic paper to counter the local Republican paper. A few years later, it switched to the Republican Party.

Herbert J. Campbell acquired the *Columbian* in 1921. A Republican. Campbell changed the editorial stance to neutral. Herbert originally published the *Columbian* in a second floor office at 215 Main St. It was later moved to a renovated post office building at Fourth and Washington, but soon suffered that space too. So, in 1928 Campbell constructed the first building in Clark County specifically designed to house a newspaper. The *Columbian* operated at this location for another 26 years until it out grew the space and moved to the site on West Eighth Street in 1955.

- Listed on the Clark County Heritage Register in 2005.

Location
Columbian Building
110 E Evergreen Blvd.
Vancouver, WA 98660
See map: [Google Maps](#)

ALBERT M. MUNGER HOUSE

Albert M. Munger House
The Munger house is a 2.5 story, frame Prairie/Craftsman style home, sometimes called a Four-square, with a low pitched hipped roof and a large front porch. The walls are finished with lapwood siding, while the third floor dormers, are wood shingled. The chimney is brick and the roof is asphalt shingles. The first floor interior reflects arts and crafts style in the built-ins and room dividers.

The house is located in the Carter Park neighborhood, a middle class area with trees on the residential side of the street. The house sits on an oversized lot which also houses a double car garage and accessory dwelling unit. The house fronts on West 28th Street with a concrete retaining wall that at some point replaced the original masonry wall. Behind the house is a landscaped yard with a new pergola built in the arts and crafts style. There are two detached garages that are not original to the house, one of which adjoins the house exterior. They were built in the 1960s and late 1990s respectively.

Albert M. Munger
This house has significance due to its original owner, Albert M. Munger. When Albert M. Munger died, his death announcement was featured on the front page of the *Columbian* newspaper. According to the article, Mr. Munger was "very widely known in Vancouver." He was chief engineer on the Vancouver-Portland ferry from 1897 until 1917. Previous to that time he was on the Stark Street Ferry in Portland. He also served on river steamers between Portland and Cascade Locks.

- Listed on the Clark County Heritage Register in 2007.

Location
Albert M. Munger House
113 W 28th St.
Vancouver, WA 98660
See map: [Google Maps](#)

HISTORIC SITES

Search Open to Public

- Any -

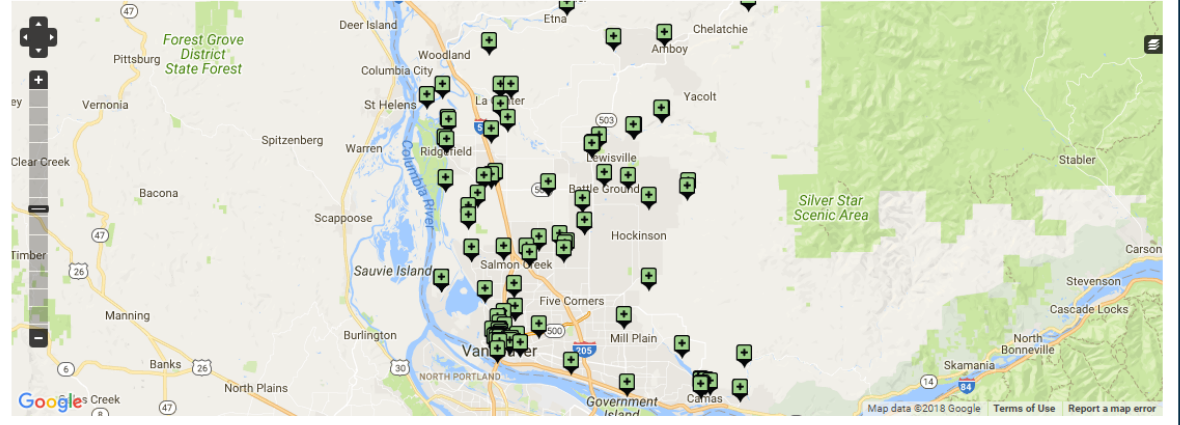

Historic Site	Did You Know?	Built
Albert and Letha Green Barn	The Greens' house and barn are the only remaining evidence of the community of Lewisville.	Circa ~ 1900
Albert and Letha Green House	This house is likely the only building remaining of the Lewisville community.	Circa ~ 1885
Albert M. Munger House	Albert Munger was the Vancouver-Portland ferry's chief engineer from 1897 to 1917.	Circa ~ 1926
Amboy United Brethren Church	The church was dedicated in 1910, though the date of construction is unknown.	Circa ~ 1900
American Legion Hall	At one time the upstairs of the building was used as a roller skating rink.	1925

PRESERVATION EDUCATION AWARD

Clark County Historic Pres. Commission



PRESERVATION EDUCATION AWARD

Clark County Historic Pres. Commission



Granite Falls Historical Society

Granite Falls

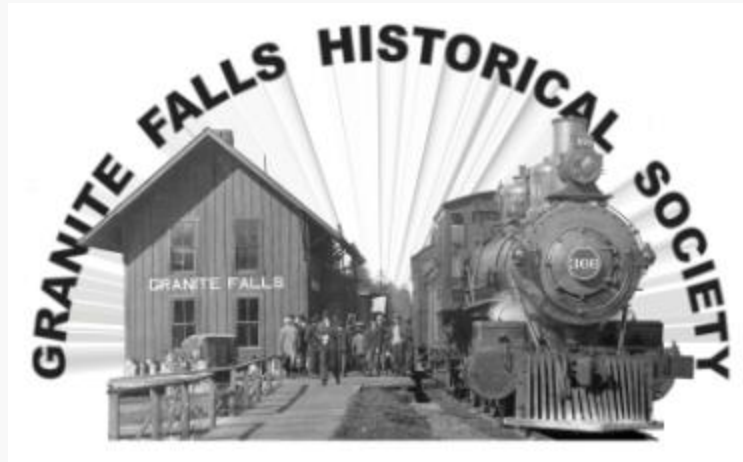

PRESERVATION EDUCATION
Award



*** "THE LITTLE MUSEUM THAT COULD" ***

Use names & keywords to search thousands of digitized pictures, documents, and newspapers back to 1922!
Marvel at the machinery, tools & clothing on display!
Open every Sunday, Noon - 5pm, and by appointment
www.gfhistory.org



PRESERVATION EDUCATION AWARD

Granite Falls Historical Society

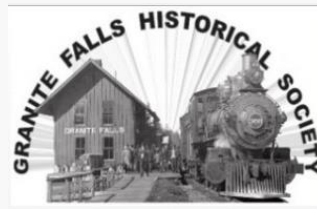

GRANITE FALLS HISTORICAL MUSEUM

"The Little Museum that Could!"

[Home](#)

Items with Images Only
 Search Hints: To search by phrase wrap your criteria in quotes. ex: "Find me"

276 results found.

- 

2004.60.3 - Print, Photographic
 Picture of unidentified **house** with four women on porch. Fence similar to fences used on E. Stanley
 Record Type: Photo
- 

2004.60.30 - Print, Photographic
 Large gathering of unidentified people in front of **house**. Given paint scheme and trim details
 Record Type: Photo
- 

2004.60.31 - Print, Photographic
 Lela Moliue in front of Sneathen **house** on Stanley St. holding dog. John Sneathen (Sneathen) was
 Record Type: Photo
- 

2004.62.30 - Print, Photographic
 Agusta Chappell, with Bessie and Martha, in front of **house**
 Record Type: Photo
- 

2004.66.19 - Print, Photographic
 , which was taken down and replaced in 1954. White **house** just across from bridge is likely the Snedin

PRESERVATION EDUCATION AWARD
 Granite Falls Historical Society

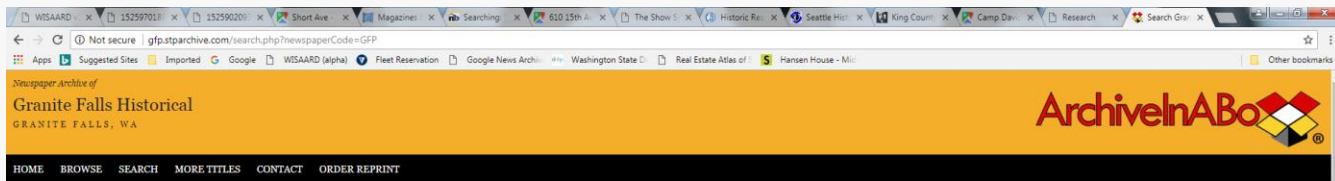

Granite Falls Historical Society & Museum

Granite Falls Historical

Search: Architect Search Max Results 10

Results of 1 - 10 of about 114 for Architect (0.397 sec.)

Granite Falls Historical 10/24/1968 Page 01 14811

HALLI left, 5th grade teacher from school in Lake Stevens, and 1st grade teacher at Granite Falls, ... as for the teacher programming and many others, [architect] have been coming 5 percent on a project over to re ... s will vary from met m o r e satisfactorily for an [architect] his fees and 7.0 to 7.5 percent. This is as thro ... for this report period. Director Carl Hemstrom An [architect], responsible. A written report will be air- state ... s that an [architect] re- m- es cover more than draw: en to the paren ... http://gfp.stparchive.com/Archive/GFP/GFP10241968P01.php?tags=architect

Granite Falls Historical 11/10/1949 Page 04 10998

! - GRANITE FALLS PRESS - GRANITE FALLS, WASHINGTON Thursday, November 10, 1949 - Granite Falls ... was a [architect] who was a pret- by good [architect] and a Russian, a staunch member of the Corran- ... on't think either of you is [architect] winter arid bad weather set in. "Before even Ad ... e there Over Armistice in 1948, there had to be did to bring some order out of the chaos." The ... http://gfp.stparchive.com/Archive/GFP/GFP11101949P04.php?tags=architect

09/26/1924 Page 07 9299

Compete for Favor ... s (two seasons has that, and the succession. Now are lef ... substantial home of your own [architect] has cleverly adapted English motifs to American re ... the custom-ary bay window of F, nglish has contrived a fine sun- porch in common with ... http://gfp.stparchive.com/Archive/GFP/GFP09261924P07.php?tags=architect

11/2/1928 Page 06 8884

RECORD GRANITE FALLS, WASHINGTON ABOUT FAIRY QUEEN ring on the tail correctly ... g in However, they say: "The [architect] wide knowledge of construction often enables him ... agree- ment, the tract Between [Architect] and Owner, pub- lished by tm American Institute o ... f [Architect], signed in es in the prese ... 6 per cent of the total cost of the building, the [architect] will draw all necessary prelia ... http://gfp.stparchive.com/Archive/GFP/GFP04121928P06.php?tags=architect

11/21/1971 Page 02 8884

July 15, 1971 Citizens' recommendations aimed to help new school planning The ... or modify it, an [architect] for the new high school. The information to be con ... committee has had as agree- ment, and Charles Murray, superintendent, Intermediate 5 ... ng, recommendation of the Robert Larson- range superintendent reported on the ... http://gfp.stparchive.com/Archive/GFP/GFP07151971P02.php?tags=architect

077 D--- 00 8156

070f9f310c84530-.jpg White Bluffs Bank 4.jpg pat_neal14.jpg

Great-Uncle Steven had a Homestead where ?!!

The first time we used the "Find" button on our electronic maps, we were searching for Steven Parr, who was an ancestor of a gentleman from New Zealand who wandered in the door ...



He had homesteaded 160 acres, at the center of which was "the" Granite Falls, after which our town is named! See the grid work on the top of the fish ladder? A surprise to everyone!

My Uncles Did What ?!!

The very first time we tried searching our newly-scanned-and-OCR'd newspapers, we searched for our museum president's granddad's last name ... "Nuhse".

After a half minute, or so, we got a surprise ...

Distillery Closed By Sheriff.

Sheriff McCulloch and deputies found a large and well equipped distillery at the old St. Leger ranch, north of this city, on Monday, which is said to have been about the best thing of its kind that has been found in Snohomish county. The equipment consisted of a still of 300 gallon capacity, smaller ones, with the nee- tures, water connections, alarm, etc. A large quantity of supplies was in the out- f. Indications were that the pl- tions were beginning at the seizure. Three men, whose names given as Henry Nuhse, Lo and Joe Bujold, were app- eared at the plant when it arrived and they were taken and the confiscated property away in automobiles and the freight truck.

Searchable Newspapers ...

Sept 12, 1924

He had Hair ?!

The day we received our scanned-and-OCR'd high school year- books, we had to investigate those museum Board members who are currently somewhat follicly-challenged ...



Tim Quillen '79 became one of our local fire- fighters, and by '94 had a slightly different hair style.



PRESERVATION EDUCATION AWARD Granite Falls Historical Society

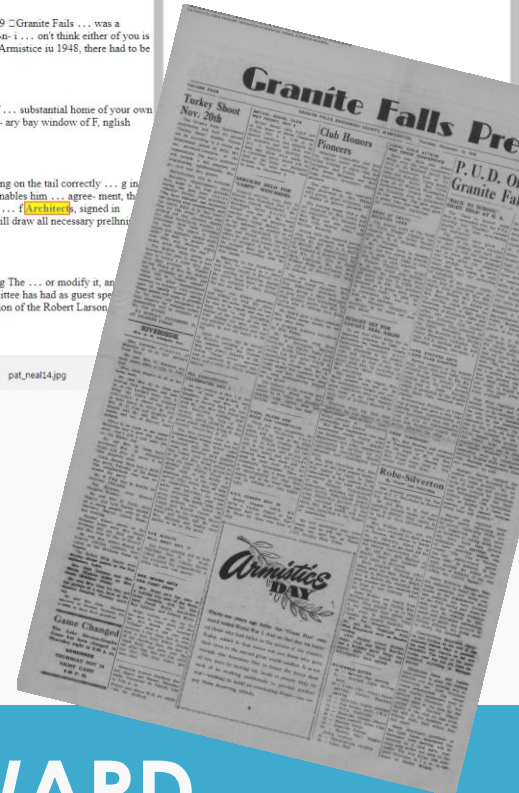

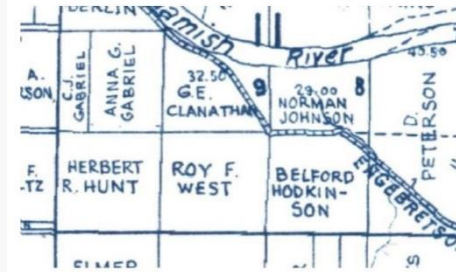
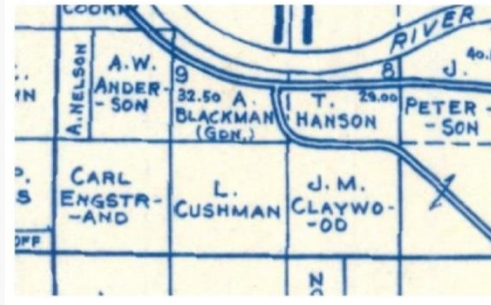
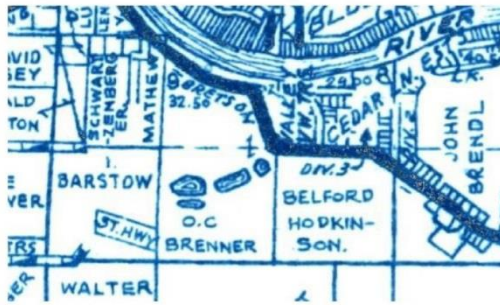

West (1952 map)

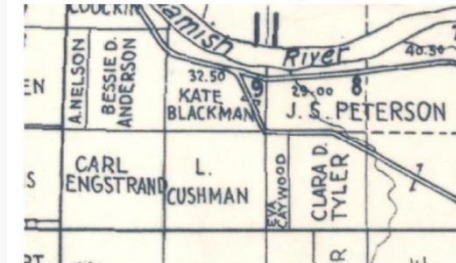

Cushman (1934 map)

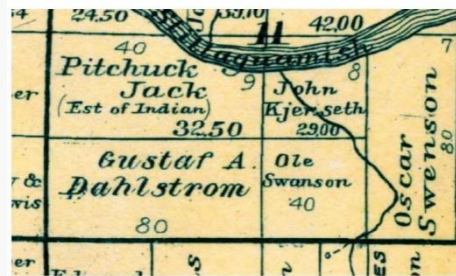

Exploring Early Snohomish County
1910 Maps overlaid on aerial photos

Searchable Online Historic Maps . . .

A story map

Granite Falls, WA, USA

Photo: GF railroad depot
GF railroad depot
Looking westward at the Granite Falls depot, NP 866 headed toward Monte Cristo.

USDA, FSA, DigitalGlobe, GeoEye, CNES/Airbus DS | Granite Falls Historical Society | Granite Falls Historical Museum... esri

PRESERVATION EDUCATION AWARD

Granite Falls Historical Society

SNOHOMISH COUNTY WASHINGTON

SELF-GUIDED MOBILE TOUR

Tour Stops

- 1 Visitor Center
- 2 Wilbur's Drug Store, 1889
- 3 Burns Block, 1882 and the Burns Brick Block, 1890
- 4 Blackman Building, 1911
- 5 Blackman Residence, 1878
- 6 Marks Building, 1889
- 7 Brown's Theater, 1924
- 8 First National Bank of Snohomish, 1907
- 9 Princess Theater, 1900
- 10 Cyphers & Robertson Saloon, 1889
- 11 A.M. Blackman Building, 1889
- 12 Eagles Hall, 1904
- 13 Carnegie Library Building, 1910
- 14 Alizza Theater, 1902
- 15 SL&B right-of-way
- 16 Cadyville Site, 1859
- 17 Ferguson Cottage, 1859
- 18 Kia Ha Ya Park, 1970s

ENTER

www.myoncell.mobi/14255070441
Or Dial (425) 307-8441 for Audio-only

ENJOY OTHER SNOHOMISH COUNTY MOBILE TOURS
www.oncell.com

SNOHOMISH COUNTY WASHINGTON

SELF-GUIDED MOBILE TOUR

There are two routes between Arlington and Granite Falls. Both Jordan Road and Burn Road provide scenic historic drives, and can be a "Short Loop" themselves.

Scrambling the Mountain Loop from Granite Falls is 24 easy miles of moderate scenery to Darrington. An additional section of trail on May 20th runs from Arlington, only four miles from 1, and only 11 miles from Granite Falls, should you choose to climb the Loop.

Tour Stops

1 Granite Falls Visitor Center	4 Lake 22 Trail	16 Rainbow Pass/Monte Cristo	28 Rodeo/Blun Grass	42 Suiattle Guard Station
2 Miller Shingle	5 Gold Basin	17 Monte Cristo Lake	29 Boulder River Trail	43 Green Mt Horse Pasture
3 Fish Ladder	6 Red Bridge	18 Goat Lake Trail	30 Fortson	44 Downey Creek Bridge
4 Canyon Creek Lodge	7 Youth-On-Age	19 Redal	31 Osio	45 Suiattle Trailhead
5 Old Robe Trail	8 Canyon Creek Lodge	20 White Chuck Bridge	32 Kangaroo Zoo	46 Green Mt. Lookout
6 Verlot Ranger Station	9 Sauk River Trail	21 Sauk River Trail	33 Arlington	
7 Mt. Pilchuck Trail	10 Big Four Ice Caves	22 Darrington	34 Pioneer Museum	
	11 Mt. Dickerman	23 Darrington Ranger Station	35 Jorden/Jordan	
			36 Rivenside School	
			37 Survey Wildlife	
			38 School 83 (#2)	
			39 Lime Kiln Trail	
			40 Paca Pride	
			41 Suiattle River Road	
			42 Boundary Bridge	
			43 Huckleberry Trailhead	

www.myoncell.mobi/13603553170
Or Dial (360) 355-3170 for Audio-only

Special Thanks to: Granite Falls Historical Society, Darrington Historical Society, Martha Zimmerman, Gordon Lindgren, David Cameron, Winterville Log Camp, Alonzo Griffin, Mary Deaton, Edith Farrell, Scott Morris, Leah Tyson, and the prospectors, miners, railroaders, bushwhackers, loggers, men of the CCC, the US Forest Service, and the pioneers who built and restored the Mountain Loop we enjoy today.

ENJOY OTHER SNOHOMISH COUNTY MOBILE TOURS
www.oncell.com

★ THE CITY OF GRANITE FALLS ★

SNOHOMISH COUNTY WASHINGTON

SELF-GUIDED MOBILE TOUR

ENJOY THIS SELF-GUIDED PHONE TOUR OF GRANITE FALLS, THE GATEWAY TO THE MOUNTAIN LOOP HIGHWAY

Snohomish.org | 888-338-0976

★ THE CITY OF SNOHOMISH ★

SNOHOMISH COUNTY WASHINGTON

SELF-GUIDED MOBILE TOUR

ENJOY SELF-GUIDED PHONE TOUR OF SNOHOMISH, ANTIQUE CAPITOL OF THE NORTHWEST

Snohomish.org | 888-338-0976

★ MOUNTAIN LOOP HIGHWAY ★

SNOHOMISH COUNTY WASHINGTON

SELF-GUIDED MOBILE TOUR

ENJOY THIS SELF-GUIDED MOBILE TOUR OF THE MOUNTAIN LOOP HIGHWAY AND SUATTLE RIVER ROAD. FAR MORE THAN JUST ANOTHER PRETTY DRIVE

Snohomish.org | 888-338-0976

PRESERVATION EDUCATION AWARD

Granite Falls Historical Society



GRANITE FALLS HISTORICAL MUSEUM

"The Little Museum that Could!"

The Granite Falls Historical Museum offers research assistance to anyone wanting to learn more about the history of Granite Falls and the valley of the South Fork of the Stillaguamish river.

Home

News and Events

Research

Get Involved

Virtual Tours

Online Store

Search our online collection

You can easily search our online collection for people, places, photos, documents, and more through the PastPerfect database. **Search our collection now!**



Search archives of newspapers

We have electronically searchable newspapers from the Granite Falls area. **Search our newspapers online!** For information on more efficient newspaper searching at the Museum, **click here.**



Overlay historic maps of Snohomish County

Wonder who homesteaded your property? Where railroads ran? Where your ancestors lived? Use our mapping system to compare everything from homestead lines to modern aerial photographs! For more information, **click here.**



Digitally Restored Images . . .

GRANITE FALLS HISTORICAL MUSEUM

"The Little Museum that Could!"

- [Home](#) Welcome to our Online Collections Database!
- [Keyword Search](#) Tips for Searching
- [Advanced Search](#) Keyword Search
- [Random Images](#)
- [Archives](#)
- [Photos](#)
- [Libraries](#)
- [Objects](#)

The **Keyword Search** button allows you to perform a general search across multiple fields for any catalog records online. Keyword searches use OR as the default connector between words (e.g. a search for **Henry Ranch** will return records associated with **Henry OR Ranch**). If you want to find records where both keywords are found, type in **AND** between the two words. To search for a specific phrase, be sure to put the phrase within quotes (e.g. **"Rocky Pine Ranch"**). You can also use the asterisk (*) as a wildcard (e.g. a search for **hatch*** would come up with records containing **hatchy, hatchess, hatchical, etc.**). Searches are not case sensitive.

The **Advanced Search** button can help you be more specific with your search. You can search for a word or phrase within a particular search category or use multiple categories to further narrow down your search results. For example, searching **White in the People**

Special Projects

New Zealander Learns Family History

A gentleman wandered in one afternoon and said, "My name is Parr and I believe I may have had some relatives in this area."

PRESERVATION EDUCATION AWARD

Granite Falls Historical Society



Spokane's Mid-Century Modern Survey

Spokane

Mid-Century Spokane home properties



Parade Plaza Parking Garage, 1967

According to the National Trust for Historic Preservation, the significant buildings of the Modern Movement are "among the most underappreciated and vulnerable aspects of our nation's heritage." Many are under threat of demolition, whether from development pressure or a widespread lack of awareness. Spokane was home to several nationally recognized Modernists, three of whom studied under Walter Gropius at Harvard (and one of these was even accepted at Frank Lloyd Wright's Taliesin). The only Richard Neutra-designed building in the entire state is here, along with what the American Institute of Architects deemed one of the five best buildings constructed in the U.S. in 1959: the Washington Water Power Central Service Facility (now home to Avista Utilities). These architects changed the face of the city – and its very personality along with it.

In 2016, the Spokane City/County Historic Preservation Office and Spokane Historic Landmarks Commission received a grant from the Washington State Department of Archaeology and Historic Preservation to start the process of identifying, documenting, and better understanding the Modern movement in Spokane. We worked alongside helveticka (a Spokane-based marketing and communications design group) and architectural historian Diana Painter, PhD, of Painter Preservation, to examine what was going on in Spokane in the middle of the 20th century; to understand why we attracted so many revolutionary architects and to learn about some of their best projects; and to help you gain an awareness of – and an appreciation for – this new area of historic preservation. The 53 representative properties we ultimately identified demonstrate both a wide range of uses and important trends in post-war Spokane.

2017 MID-CENTURY SURVEY REPORT



helveticka



Painter Preservation
HISTORIC PRESERVATION & URBAN DESIGN

MEDIA
Award



Spokane Mid-20th Century Architectural Survey Report



Modern architect in Spokane in the pre-war years was J. ...
 1941 Davenport Parking Garage. His own 1942 residence
 focused largely on residential design within this timeframe.

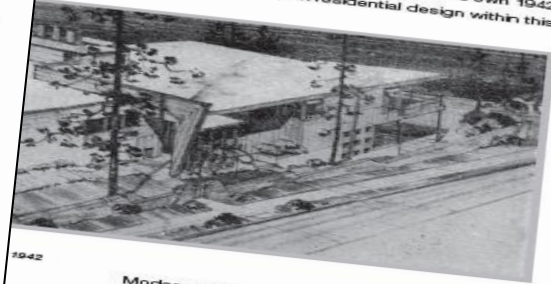

What skysc
 Lesco
 1929
 was a
 new f
 Intern
 curati
 Russ
 John
 and a
 Style,
 the st
 it was
 depa

1942
 Modern architecture had its genesis in Europe between the
 housing stock had been decimated sought to rebuild in w
 needs. Architects and planners from the continent looked
 building stock to house workers earlier in the century in t
 the same time, new standards, rejecting outmoded histo

r house in Spokane in 1961.
 Architectural Survey and Inventory. Prepared for the Montana State Historic Preservation Office
 direct for the Harford Engineering Works (HEW) Village during World War II.
 Equitable Building in Portland was constructed 1944-1946, the first post-war curtain wall structu





MEDIA AWARD

Spokane's Mid-Century Modern Survey



Mid-Century Spokane

home properties

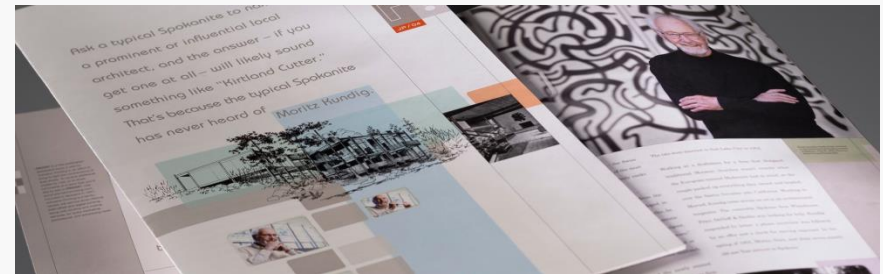

MEDIA AWARD Spokane's Mid-Century Modern Survey

Spokane Historic Landmarks
Published by Megan Kelly Duvall [?] · September 28, 2017 ·

Mid-Century Spokane | 39 of 52

The 1963 True house, designed by Spokane architect Warren Cummings Heylman, differs from the typical Contemporary house in a number of ways, among them the barrel vaults that make up the roofline.



True House
Property: True House Built: 1963 Address: 4320 South Napa Street Architect: Warren Cummings Heylman The Paul L. and Martha J. True house is designed in what, in the 1950s and 1960s, was often called the "Contemporary" style. MIDCENTURYSPOKANE.ORG

Spokane Historic Landmarks
Published by Megan Kelly Duvall [?] · October 12, 2017 ·

Mid-Century Spokane | 41 of 52 One of only two extant Richard Neutra structures in the Pacific Northwest, the 1951 Fischer house is designed in the International Style.



Fischer House
Property: Fischer House Built: 1951 Address: 1618 East Pinecrest Road Architect: Richard Neutra Dr. Frederick R. Fischer commissioned renowned Los Angeles architect Richard Neutra to design a home for Fischer and his family in 1951.... MIDCENTURYSPOKANE.ORG

Spokane Historic Landmarks
Published by Megan Kelly Duvall [?] · October 5, 2017 ·

Mid-Century Spokane | 40 of 52

St. Charles Borromeo Catholic Church represents a masterful integration of art and architecture by the firm of Funk, Murray and Johnson, Spokane artist Harold Balazs, and French stained glass artist Gabriel Loire.



St. Charles Borromeo Catholic Church
Property: St. Charles Borromeo Catholic Church Built: 1961 Address: 4515 North Alberta Street Architect: Funk, Murray & Johnson The St. Charles Borromeo Catholic Church represents a masterful integration of art and architecture by the... MIDCENTURYSPOKANE.ORG

Spokane Historic Landmarks
Published by Megan Kelly Duvall [?] · January 19, 2017 ·

For our third week, we'll take a "dive" into an industrial mid-century structure...one you may recognize!



Shadle Park Reservoir
Mid-Century Spokane | 3 of 52 Designed by city utilities engineering staff, the 1965 Shadle Park Reservoir received national recognition not only for "aesthetic beauty," but also for its functional qualities. MIDCENTURYSPOKANE.ORG

Spokane Historic Landmarks
Published by Megan Kelly Duvall [?] · January 5, 2017 ·

The significant buildings of the Modern Movement are, according to the National Trust for Historic Preservation, "among the most underappreciated and vulnerable aspects of our nation's heritage." So let's appreciate Spokane's very own Modern legacy -- by taking a look at a building a week throughout 2017.



Parkade
Mid-Century Spokane | 1 of 52 A symbol of new life in the heart of Spokane, the 1967 Parkade Plaza Parking Garage was designed by Warren C. Heylman to accommodate 970 automobiles. MIDCENTURYSPOKANE.ORG



MEDIA AWARD
Spokane's Mid-Century Modern Survey



Kate Pogue Rau Ooooh, that's a cool one!
 Like · Reply · 19w

facebook

Steve Berde Very cool house
 Like · Reply · 21w

Sheryl Russell Tony Will, I love this house. I've loved all of your dad's work you've posted. I wish there were photos of the inside of the house. I'd like to see photos of your family home he designed. Do you have any photos of your home in Spo...
 Like · Reply · 38w

Neil Kinkel This house is a couple blocks from us - have driven past it for 20 years and admired it - never knew it was a Richard Neutra. He came from Europe in the 1920's - was on the cover of Time in 1949. This blows me away.
 Like · Reply · 29w · Edited

MEDIA AWARD Spokane's Mid-Century Modern Survey



Janet Rogerson

Bellingham



PRESERVATION PLANNING
Award

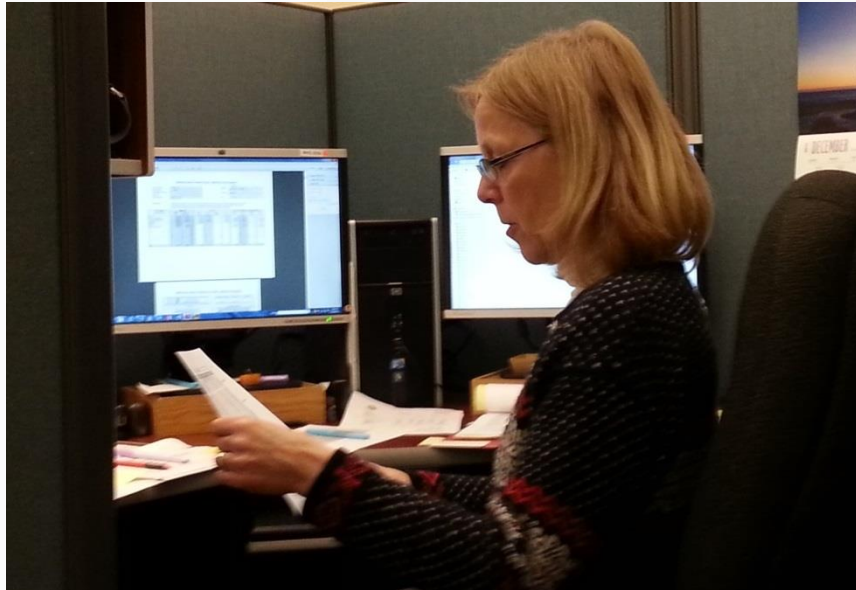

PRESERVATION PLANNING AWARD

Janet Rogerson



PRESERVATION PLANNING AWARD

Janet Rogerson

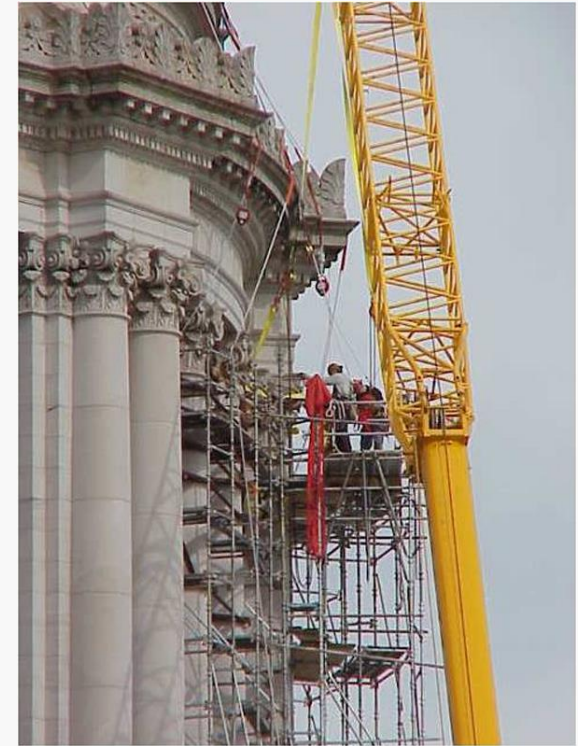

PRESERVATION PLANNING AWARD

Janet Rogerson



**American Planning Association
 Washington Chapter
 Community Planning Assistance Request Form**

The Washington Chapter of the American Planning Association offers communities (cities, towns, neighborhoods, or rural villages) no-cost assistance of professional planners and other specialists in articulating visions, solving problems or resolving issues. The following briefly describes our program, how you can participate, and how we can create a partnership.

What APA Washington can bring
 APA Washington members include planners with expertise in land use, transportation, economic development, urban design, natural resources, parks and recreation, historic preservation, and other areas. There are members all over the state. In addition, we are affiliated with the planning schools across the state and we are accustomed to working with diverse community groups, leading to progressive solutions.

APA Washington will organize teams suited to your local needs, sized to your community, and committed to leaving you with tangible products. We promise to be objective in our outlook, inclusive in our process, and available to offer advice afterwards.

Here's how it works

1. **Community Sponsorship** – An organization (City Council, Planning Commission, Community Council, etc.) elects to be the sponsor.
2. **Identify the Problem** – The sponsor completes the short form below.
3. **Meet with the "Advance Team"** – APA Washington members will meet with you to discuss the preliminary problem statement, the sponsor's obligations, and plan the event.
4. **Schedule the Event** – Once a date is picked, the sponsor will reserve the work space, arrange for catering and supplies and most importantly – publicize the event in the community.
5. **Do It!** – While the actual agenda will depend upon the community and the problem, general outline of activities may include group brainstorming, walking and/or driving tours, small group work on solutions, and a public open house.
7. **Implementation** – APA Washington produces a final report on the event and submits it to the sponsor approximately on month later. Team members are on-call to offer advice.

Contact Information

The short form below is designed to give APA Washington more information about your need for Community Planning Assistance. Be sure to answer each question clearly and with as much detail as possible. After reading the application, please contact Janet Rogerson with questions you may have at 360-725-3047.



PRESERVATION PLANNING AWARD
 Janet Rogerson



PRESERVATION PLANNING AWARD

Janet Rogerson

Malachi Simper

Chehalis



CEMETERY PRESERVATION
Award



WASHINGTON LAWN CEMETERY RESTORATION
 Malachi Simper's Eagle Scout Project Boy Scouts of America Troop 519
 In cooperation with The City of Centralia and The George Washington Committee
Saturday May 13, 2017 9am-3pm
 Washington Lawn Cemetery
 615 North Washington Ave Centralia, WA 98531
 (Next to Edison Elementary School)

My project will help prepare the Washington Lawn Cemetery Memorial Day and the George Washington Celebration. George Washington is the founder of Centralia and this is his final resting place. Restoring this Cemetery will show respect for those who have gone before us.

This Project will include removing moss and dirt from the above ground vaults and walls. Surfaces will be cleaned with scrub brushes in preparation for a fresh coat of paint. We will prune hedges and low hanging trees. We will weed eat along the fence line, around headstones and the entrance to the cemetery. We will also be planting trees along the west fence line. All debris will be moved to the roadway for removal by the City.

Anyone wishing to volunteer is welcome. Volunteers are encouraged to bring their own bucket and scrub brush. If You have any skills or equipment that would be useful for this project, Please contact Malachi Simper at simperca@yahoo.com

CEMETERY PRESERVATION AWARD

Malachi Simper



CEMETERY PRESERVATION AWARD

Malachi Simper



CEMETERY PRESERVATION AWARD

Malachi Simper

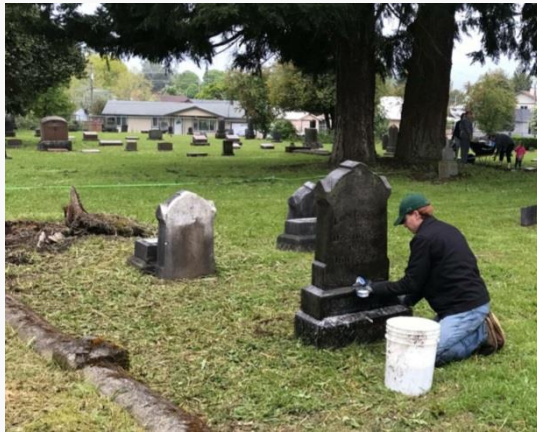

CEMETERY PRESERVATION AWARD

Malachi Simper



CEMETERY PRESERVATION AWARD

Malachi Simper



Patrick Neal

Clallam County



SPECIAL ACHIEVEMENT
Award



PAT NEAL: A short history of tourists

By Pat Neal

Wednesday, July 5, 2017 1:30am

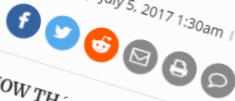

OPINION | CLALLAM COUNTY | JEFFERSON COUNTY

NOW TH

se-

tourists are finally here it's easy to remember why we put a mean to the melting glaciers the Olympic Peninsula has for tourists.

in the good old days of the Bearing Land Bridge hunters crossed from Siberia to Alaska and warmer weather.

PAT NEAL'S WILDLIFE: Digging up the oldest fishing law

By Pat Neal

Wednesday, April 7, 2010 12:01am



THANK YOU FOR reading this.

Sometimes I think if you didn't read this, no one would. But you do. I get mail from faraway places — like Oregon — asking: "If you dislike the birds so much, why do you watch them?"

"I have ever tried to do as a weekly wilderness gossip columnist was to ... of the silence of nature. ...ing on Earth. ... the silence of the wilderness, I am ...role of some river pest,

Pat Neal

135 Stories | Page 1 of 7

PAT NEAL: The Olympic Peninsula Treasure Hunt

By Pat Neal

Wednesday, April 4, 2018 1:30am



OPINION | CLALLAM COUNTY | JEFFERSON COUNTY

OVER THE YEARS there have been many stories, legends and fables of lost treasures buried in the Olympic Peninsula. One of which is the several tons of treasure that Sir Francis Drake sailed north to the coast of North America in 1579.



PAT NEAL: The spud and I

THERE ARE FEW things more enjoyable to a gardener than planting potatoes. They are easy to plant. In fact, you can often just replant the...

[Continue reading](#)

May 9, 2018

OPINION | CLALLAM COUNTY | JEFFERSON COUNTY

PAT NEAL: Sequim Irrigation Festival time again

IT'S TIME ONCE again for the Sequim Irrigation Festival, where we commemorate water being brought to the Sequim Prairie. This is the oldest community celebration...

[Continue reading](#)

May 2, 2018

OPINION | CLALLAM COUNTY | JEFFERSON COUNTY

PAT NEAL: The evils of ro stacking

IT WAS DAYLIGHT on the river with a heavy fog hugging close to the water. As the sky grew lighter the outline of the distant...

[Continue reading](#)

Apr 25, 2018

OPINION | CLALLAM COUNTY | JEFFERSON COUNTY

SPECIAL ACHIEVEMENT AWARD Pat Neal



SPECIAL ACHIEVEMENT AWARD Pat Neal



Health/Medicine

SURVEY-INVENTORY FORM
COMMUNITY CULTURAL RESOURCE SURVEY

Size: 5-149
S: 1524/1122

1. NAME: McGilivray House
Historic

2. LOCATION: Block 35, Lot 9
City, Town: Port Angeles
State: Washington

3. CLASSIFICATION: private
Ownership: occupied
Present Use: religious

4. OWNER OF PROPERTY: Leonard Eder
Street & Number: 212 N. Vine
City, Town: Port Angeles
State: Washington

5. MAJOR BIBLIOGRAPHICAL REFERENCES: Seattle Times, Sept. 30, 1962; Jimmy Come Lately, History of Clallam County

6. FORM PREPARED BY: Pat Neal, Historical Planner
Organization: Clallam County Parks & Recreation
Street & Number: Clallam County Courthouse
City or Town: Port Angeles
Date: 1979-80
Telephone: 452-7831 - ext. 291
State: Washington 98262

Form AHP S-2 (6/78)



6. FORM PREPARED BY:

Name/Title	
Pat Neal, Historical Planner	1979-80
Organization	Date
Clallam County Parks & Recreation	
Street & Number	Telephone
Clallam County Courthouse	452-7831 - ext. 291
City or Town	State
Port Angeles	Washington 98262

Form AHP S-2 (6/78)

Special Achievement Award

Patrick Neal



Special Achievement Award

Patrick Neal



Special Achievement Award

Patrick Neal



Melissa McGinnis

Tacoma



CAREER ACHIEVEMENT
Award



CAREER ACHIEVEMENT AWARD

Melissa McGinnis



CAREER ACHIEVEMENT AWARD
Melissa McGinnis



Point Defiance Streetcar Station



CAREER ACHIEVEMENT AWARD
Melissa McGinnis

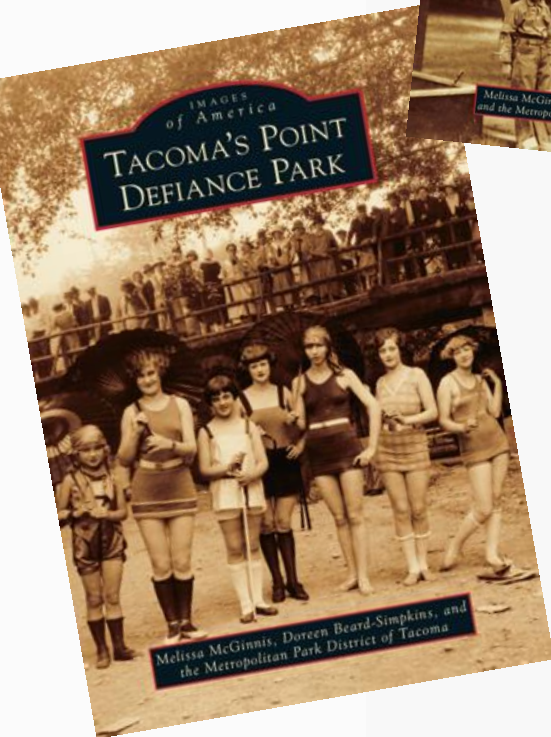
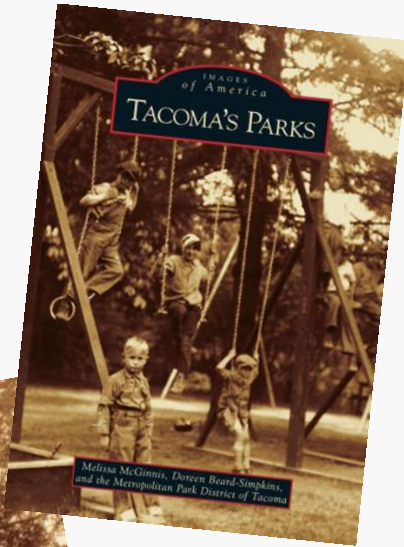

CAREER ACHIEVMENT AWARD Melissa McGinnis



Point Defiance Lodge



CAREER ACHIEVEMENT AWARD
Melissa McGinnis



CAREER ACHIEVEMENT AWARD

Melissa McGinnis



Justine James

Taholah



CAREER ACHIEVEMENT
Award

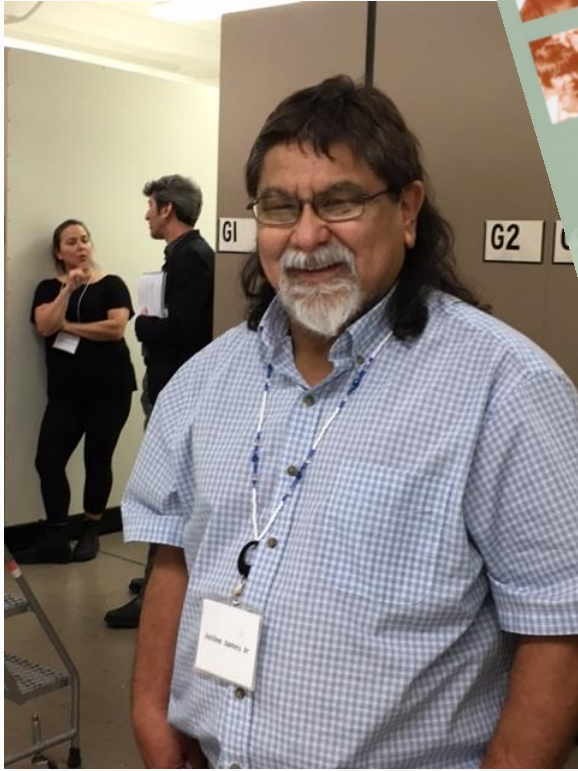
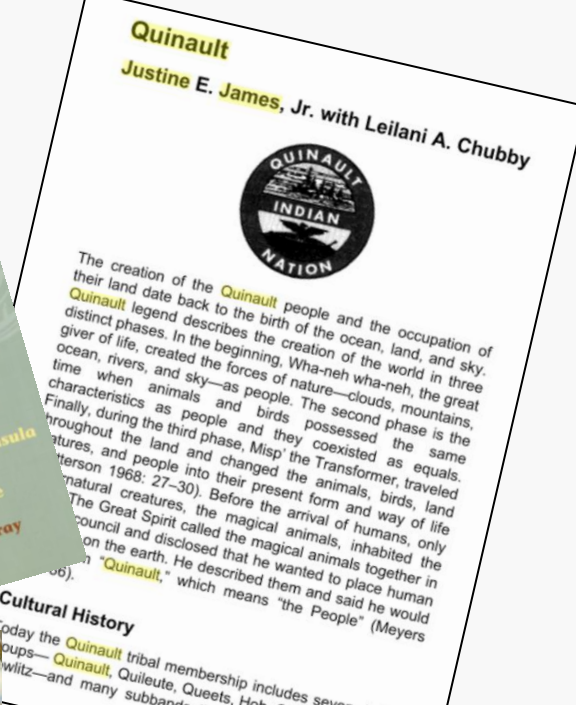
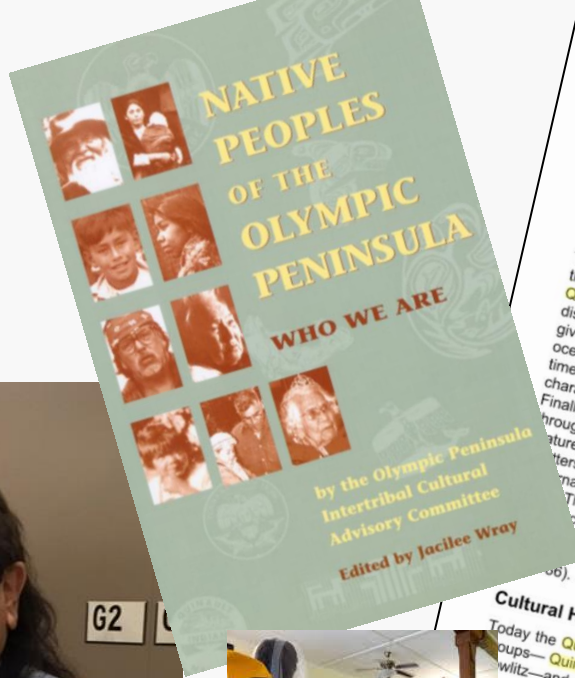

CAREER ACHIEVEMENT AWARD

Justine James

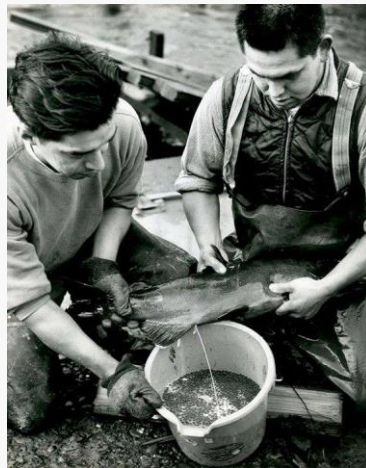
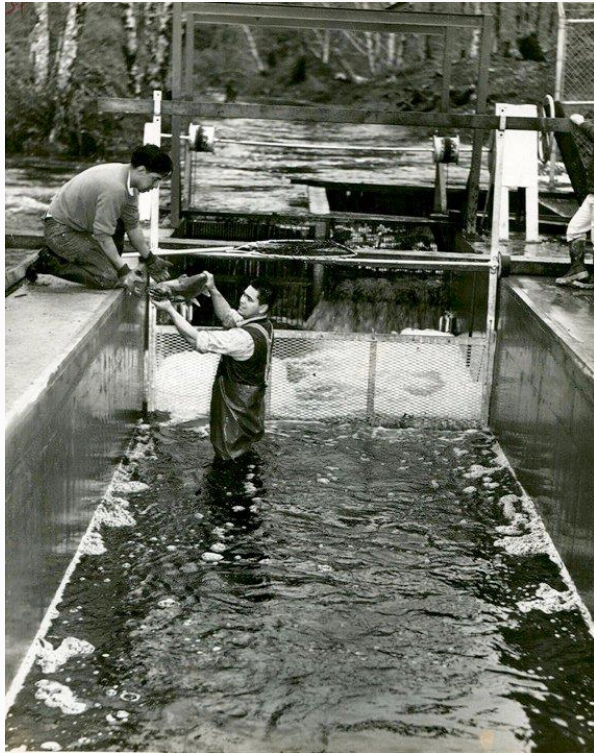

CAREER ACHIEVMENT AWARD

Justine James

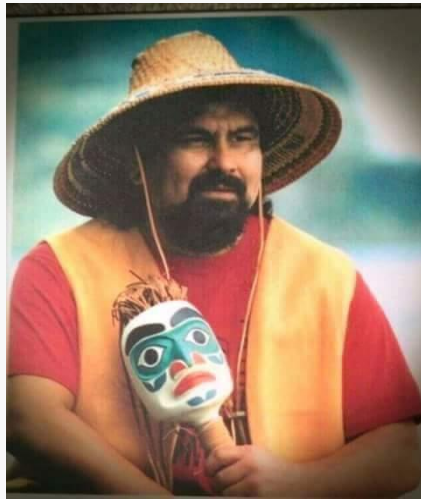

CAREER ACHIEVEMENT AWARD

Justine James



CAREER ACHIEVEMENT AWARD

Justine James



CAREER ACHIEVEMENT AWARD

Justine James

Kramlich Barn

Colfax



HERITAGE BARN REHABILITATION AWARD
Award

After

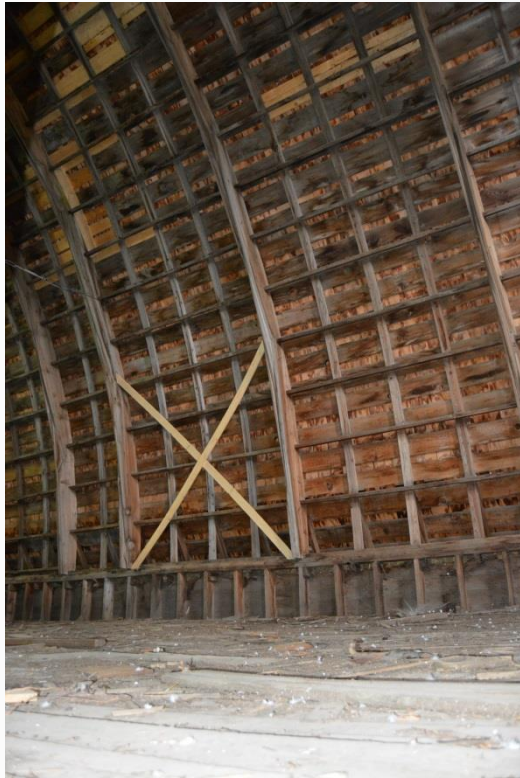

HERITAGE BARN REHABILITATION AWARD

Kramlich Barn

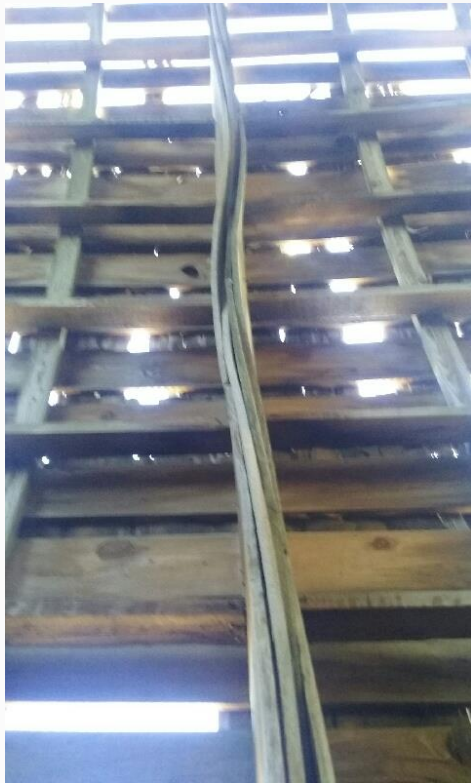

Before

HERITAGE BARN REHABILITATION AWARD

Kramlich Barn



During

HERITAGE BARN REHABILITATION AWARD

Kramlich Barn



During

HERITAGE BARN REHABILITATION AWARD

Kramlich Barn

After



HERITAGE BARN REHABILITATION AWARD
Kramlich Barn



HERITAGE BARN REHABILITATION AWARD

Kramlich Barn

Quilcene Hist. Society

Quilcene



STEWARDSHIP
Award

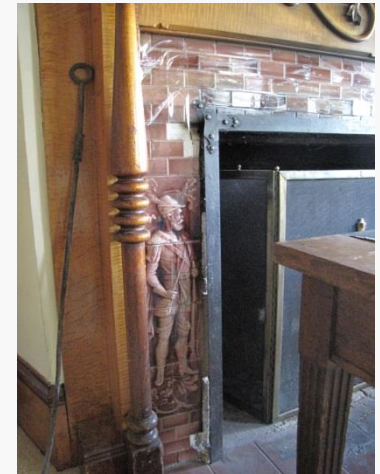

STEWARDSHIP AWARD

Hamilton-Worthington House



STEWARDSHIP AWARD

Hamilton-Worthington House



STEWARDSHIP AWARD

Hamilton-Worthington House



STEWARDSHIP AWARD

Hamilton-Worthington House



STEWARDSHIP AWARD

Hamilton-Worthington House



STEWARDSHIP AWARD

Hamilton-Worthington House



STEWARDSHIP AWARD

Hamilton-Worthington House



STEWARDSHIP AWARD

Hamilton-Worthington House

White Bluffs Bank

Hanford



VALERIE SIVINSKI
Award for Historic Rehabilitation

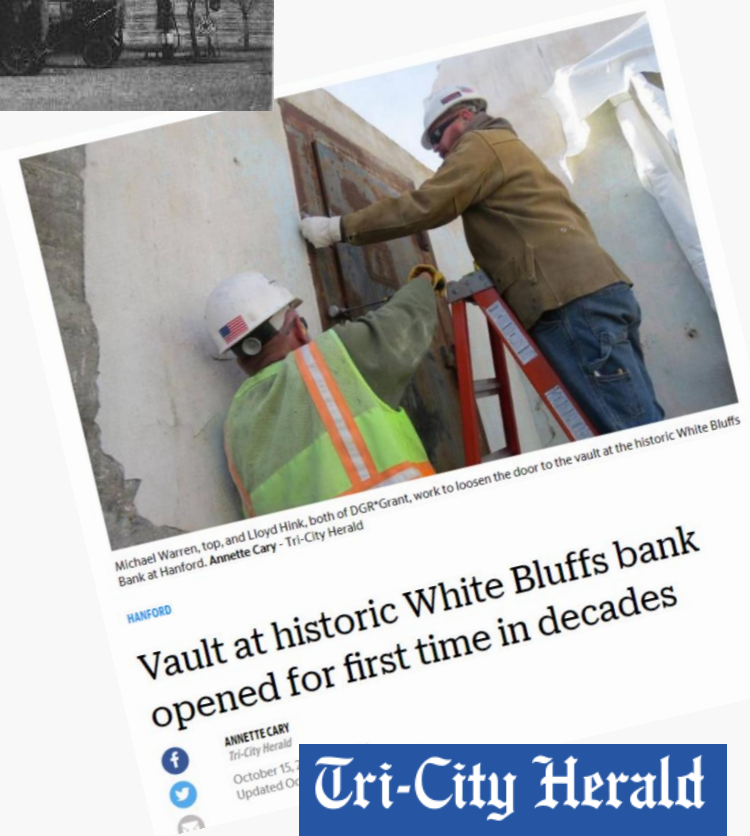

VALERIE SIVINSKI

Award for Historic Rehabilitation

Before



VALERIE SIVINSKI
Award for Historic Rehabilitation

Before



VALERIE SIVINSKI
Award for Historic Rehabilitation



VALERIE SIVINSKI

Award for Historic Rehabilitation



VALERIE SIVINSKI

Award for Historic Rehabilitation

After



VALERIE SIVINSKI
Award for Historic Rehabilitation

After



VALERIE SIVINSKI
Award for Historic Rehabilitation

After



VALERIE SIVINSKI
Award for Historic Rehabilitation



Cheney High School

Cheney



VALERIE SIVINSKI
Award for Historic Rehabilitation

Before



VALERIE SIVINSKI
Award for Historic Rehabilitation



Before



VALERIE SIVINSKI
Award for Historic Rehabilitation

During



VALERIE SIVINSKI
Award for Historic Rehabilitation

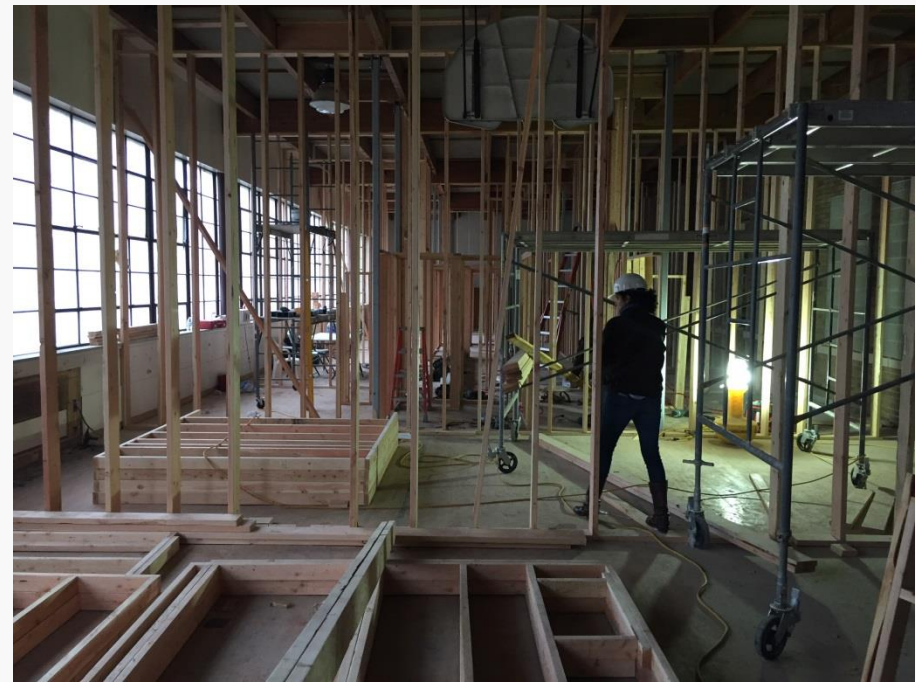

During



VALERIE SIVINSKI
Award for Historic Rehabilitation



After



VALERIE SIVINSKI
Award for Historic Rehabilitation



After

VALERIE SIVINSKI
Award for Historic Rehabilitation



After

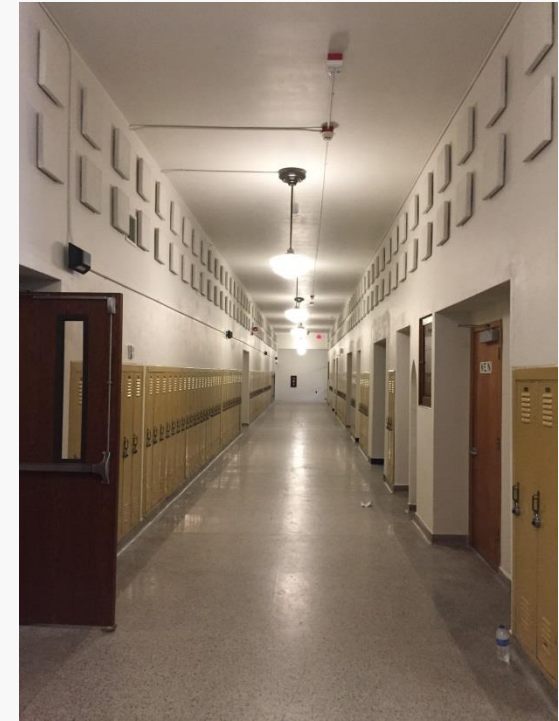
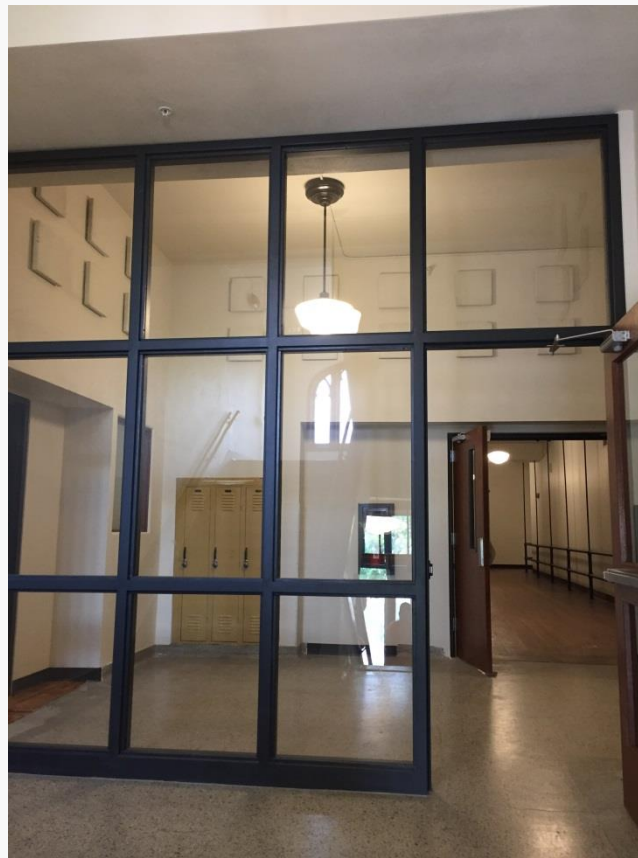

VALERIE SIVINSKI
Award for Historic Rehabilitation



After



VALERIE SIVINSKI
Award for Historic Rehabilitation



LIVE | LEARN | COLLABORATE

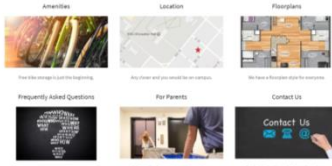

VALERIE SIVINSKI
Award for Historic Rehabilitation



National Historic

Preservation Month



WASHINGTON STATE
**HISTORIC
PRESERVATION
MONTH**

State Historic Preservation Officer

Award Ceremony – May 15, 2018