

LUMBER
DIRECT FROM
MILL TO
YOU

CATALOG NO. 10

221/0
211/0

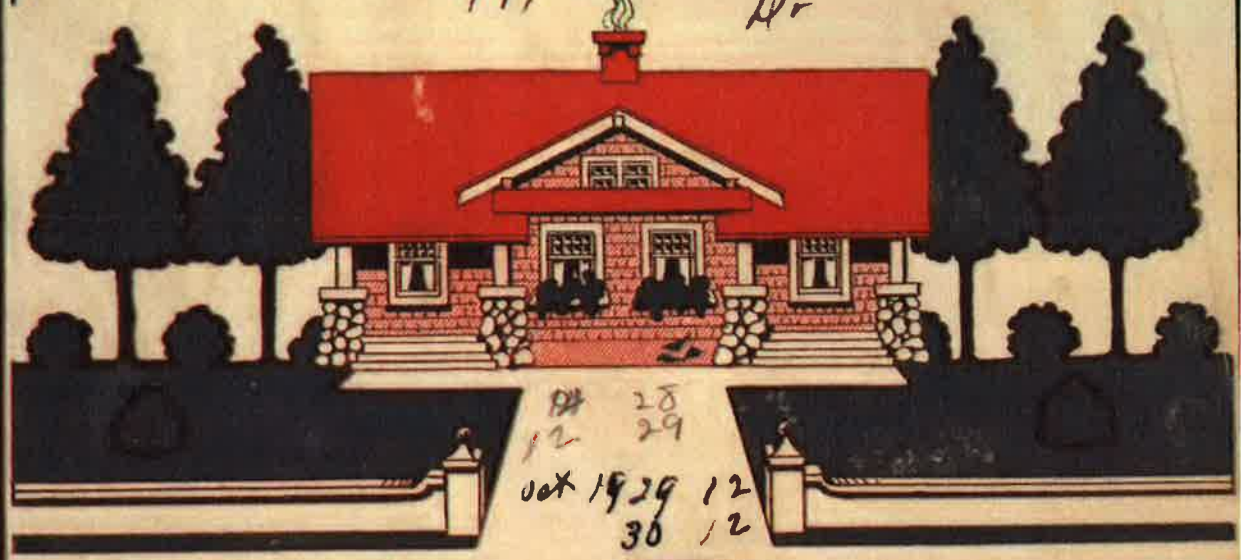

PLAN BOOK

PAGE
51

AND CATALOGUE

128 114

128

CONTRACTORS LUMBER SUPPLY

SEATTLE, CO. WASH.

UP-TO-DATE BARN

The barns illustrated on the following pages have been designed by our practical architects with years of experience to meet the requirements of the modern farmer and stock raiser.

It is merely a matter of individual preference in making a selection of any one of the several designs shown. They are all rigidly constructed of the very best grade of No. 1 Fir Dimension lumber, which is now recognized the world over as the strongest and most substantial framing lumber that can be obtained. The plans have been worked out to obtain the greatest amount of useful space for the least cost.

General Specifications

Our barns are designed to set either on concrete or masonry foundations or piers. In ordering plans for barns shown on the following pages, please state the kind of foundation you expect to use. Our reason for asking this information is, that we supply a 4x6 for masonry or concrete foundation, and a 6x6 sill for barn set on piers.

All foundation and framing lumber in our barns is best grade of No. 1 Fir Dimension lumber, dressed on one side and one edge. (For sizes see detailed specifications below.) Roof sheathing is No. 1 Common Fir Boards dressed one side, random width and lengths laid solid. Siding is 1x6 No. 2 Clear and Better Fir drop siding, which is the best grade made. Roof is covered with best quality of Extra *A* Red Cedar shingles. Following is a detailed specification of sizes and kinds of materials used:

SILLS	4x6 for concrete foundation.
"	6x6 when set on piers.
STUDS	2x6, 24 inches on center.
PLATES	2x6, laid double.
RAFTERS	2x6, 24 inches on center.
MOW JOISTS	3x8, 24 inches on center for smaller barns.
"	2x10, 24 inches on center for large barns.
GIRDERS	6x8.
POSTS	6x6.
STALL PARTITIONS	2x12.
MANGER FRONTS	2x12.
MOW FLOOR	1x6 D&M Fir Flooring.
SIDING	1x6 best grade Clear Fir Drop Siding.
ROOF BOARDS	No. 1 Common Fir S1S, random widths and lengths.
SHINGLES	Extra *A* Red Cedar.
DOOR MATERIAL	4 in. Clear Fir Ceiling.
OUTSIDE FINISH	Best grade Clear Soft Fir.
TRACK BEAM	4x6 Select Common.
SASH	8x10, 4 lights.

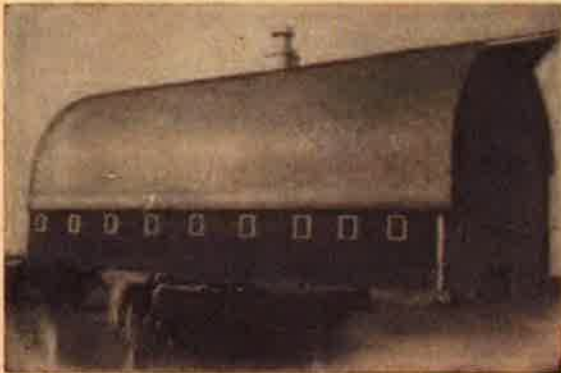

Devils Lake, N. D., Oct. 25, 1919.

Contractors Lumber Supply Co.
Seattle, Washington.

Sirs:

I am enclosing two kodak pictures of my barn built from the lumber ordered from your company. I have been entirely satisfied in every respect with the dealings through your firm and sometime within the next year or two when we build a house perhaps we may be able to do business also.

I am pleased to have rendered this little service to your company and will look for a copy of the book for 1920.

Very truly yours,

B. A. OSBORNE.

If the retail lumber dealer offers to meet our price or comes anywhere near it, it will be at your expense. We sell you lumber at wholesale mill price and if the retail dealer offers to sell at our figure he is sacrificing all his profit. If he cuts his price isn't it only natural that he would try to make up for it in another way? Failing to get the price originally asked he will try to substitute poor grades and add a big bill for "extras."

CONTRACTORS LUMBER SUPPLY COMPANY, SEATTLE, WASH.

UP-TO-DATE BARNs

The barns illustrated on the following pages have been designed by our practical architects with years of experience to meet the requirements of the modern farmer and stock raiser.

It is merely a matter of individual preference in making a selection of any one of the several designs shown. They are all rigidly constructed of the very best grade of No. 1 Fir Dimension lumber, which is now recognized the world over as the strongest and most substantial framing lumber that can be obtained. The plans have been worked out to obtain the greatest amount of useful space for the least cost.

General Specifications

Our barns are designed to set either on concrete or masonry foundations or piers. In ordering plans for barns shown on the following pages, please state the kind of foundation you expect to use. Our reason for asking this information is, that we supply a 4x6 for masonry or concrete foundation, and a 6x6 sill for barn set on piers.

All foundation and framing lumber in our barns is best grade of No. 1 Fir Dimension lumber, dressed on one side and one edge. (For sizes see detailed specifications below.) Roof sheathing is No. 1 Common Fir Boards dressed one side, random width and lengths laid solid. Siding is 1x6 No. 2 Clear and Better Fir drop siding, which is the best grade made. Roof is covered with best quality of Extra *A* Red Cedar shingles. Following is a detailed specification of sizes and kinds of materials used:

SILLS	4x6 for concrete foundation.
"	6x6 when set on piers.
STUDS	2x6, 24 inches on center.
PLATES	2x6, laid double.
RAFTERS	2x6, 24 inches on center.
MOW JOISTS	2x8, 24 inches on center for smaller barns.
"	2x10, 24 inches on center for large barns.
GIRDERS	6x8.
POSTS	6x6.
STALL PARTITIONS	2x12.
MANGER FRONTS	2x12.
MOW FLOOR	1x6 D&M Fir Flooring.
SIDING	1x6 best grade Clear Fir Drop Siding.
ROOF BOARDS	No. 1 Common Fir S1S, random widths and lengths.
SHINGLES	Extra *A* Red Cedar.
DOOR MATERIAL	4 in. Clear Fir Ceiling.
OUTSIDE FINISH	Best grade Clear Soft Fir.
TRACK BEAM	4x6 Select Common.
SASH	8x10, 4 lights.



Devils Lake, N. D., Oct. 25, 1919.

Contractors Lumber Supply Co.
Seattle, Washington.

Sirs:

I am enclosing two kodak pictures of my barn built from the lumber ordered from your company. I have been entirely satisfied in every respect with the dealings through your firm and sometime within the next year or two when we build a house perhaps we may be able to do business also.

I am pleased to have rendered this little service to your company and will look for a copy of the book for 1920.

Very truly yours,

B. A. OSBORNE.

If the retail lumber dealer offers to meet our price or comes anywhere near it, it will be at your expense. We sell you lumber at wholesale mill price and if the retail dealer offers to sell at our figure he is sacrificing all his profit. If he cuts his price isn't it only natural that he would try to make up for it in another way? Failing to get the price originally asked he will try to substitute poor grades and add a big bill for "extras."

CONTRACTORS LUMBER SUPPLY COMPANY, SEATTLE, WASH.

OUR FREE PLAN OFFER

We have prepared at great expense complete plans, blue prints and specifications fully explaining every detail of the construction of the barns shown on following pages.

These plans, blue prints and specifications are absolutely free to our customers. All we ask is a deposit of \$3.00 to protect ourselves from curiosity seekers and the agents of retail lumber yards, who would order plans just to put us to trouble and unnecessary expense.

When material is purchased from us, we allow you credit for the \$3.00 deposited, so the plans will not cost you anything. We furnish with the plans a complete set of specifications, and material list describing all material and its location in the building, so that anyone having a reasonable experience in building construction will have no trouble in erecting the barn.

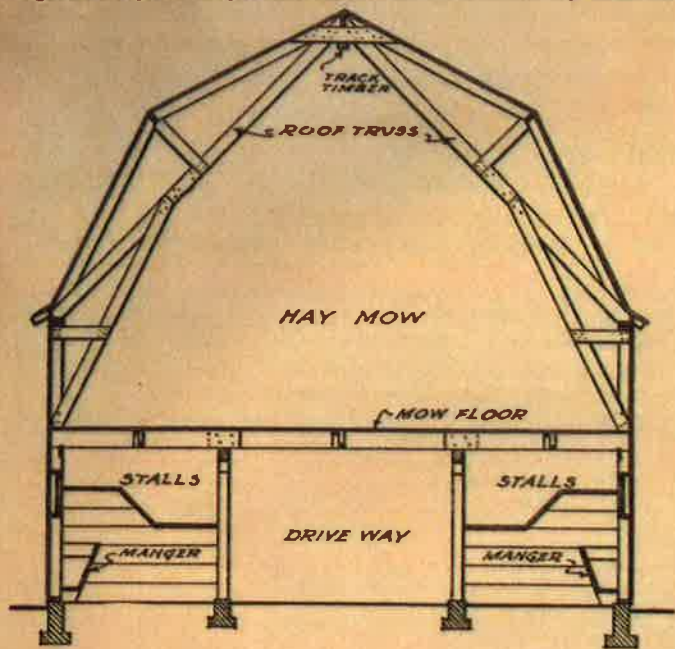

SECTION OF GAMBREL ROOF BARN

The above cut illustrates the construction of truss for our Gambrel roof barns. The principal rafters, the sway braces, collar ties and other braces are of heavy plank, the size depending upon the size of barn, and are all doubled, two pieces of each being used where only one piece of each is visible in section above. This makes a doubly strong truss, and it will withstand the heaviest strain. From grade line to mow floor, the above cut shows a typical construction found in all our barns.

and all structural features. This preliminary sketch gives you a good outline of your ideas worked out in a practical way. This will be sent to you for your approval, corrections and further suggestions. You can then return the sketch to us with your corrections noted, together with \$5.00 additional, and we will make you a complete set of blue print plans. These plans consist of floor plan, sectional elevation, end elevation, side elevation, and other details. With these plans we will send you our guaranteed material specification estimate, describing the quality, kind and size of all material to be furnished, also quoting you a **GUARANTEED PRICE F. O. B. Cars**, your station. This entire outfit will cost you only a temporary deposit of \$10.00 which will be refunded when material is purchased from us. You will thus get complete plans according to your own ideas absolutely free.

NO MONEY DOWN are the terms we offer. We take all the risk. Shipments made subject to your inspection. We let you be the judge. See our terms of sale on first pages of this catalogue.

SPECIAL PLAN OFFER

Realizing that no two farmers may need the same size and arrangement of barn, we have established a special barn plan department, which is also free to our customers.

In case you do not find a barn plan in this book which conforms to your ideas, or one than can not be made to suit you by making slight alterations, simply send us a rough sketch and description of the plan you want to use, stating the width, length, height of studs, kind of roof construction, and any other information you can think of, together with a deposit of \$5.00, on receipt of which we will furnish you with an expert architect's preliminary blue print sketch of barn, drawn to scale, consisting of floor plan, showing location of stalls, mangers, bins, stairway, etc.; and a sectional framing elevation showing construction and style of roof

"I SAVED \$200 IN BUYING FROM YOU"

Contractors Lumber Supply Co.
Seattle, Washington.

Colony Bay, Montana, Dec. 5, 1919.

Gentlemen:

In reply to your letter am sorry to say that I have no picture of my barn. I have the best barn in this part of the country and the lumber that I got of you was better than I could have got at any of the yards here; besides I saved \$200.00 in buying from you. I will send you photo when I have some made.

W. B. STURGILL.

CONTRACTORS LUMBER SUPPLY COMPANY, SEATTLE, WASH.

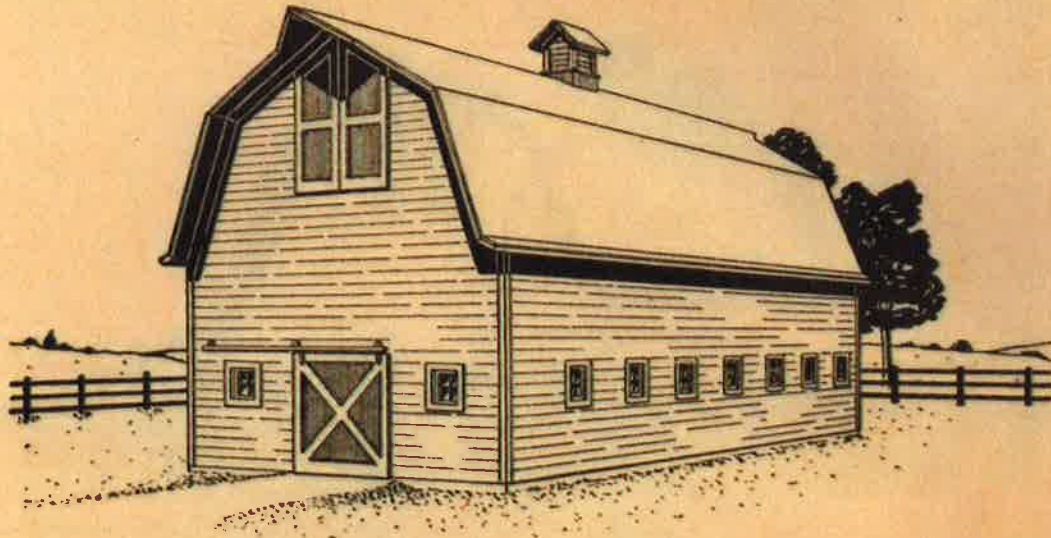

Barn Design No. 180

The above cut illustrates the popular and practical Gambrel roof barn which is a favorite with a big majority of barn owners.

The floor plan shown on this page presents a practical and convenient arrangement which meets with the demand for a combination horse and cow barn. This arrangement may be modified to suit the special needs of the individual farmer, without materially increasing the cost.

Below you will find a list of stock sizes for which blue print plans and specifications can be furnished by return mail. For sizes other than shown below, we will furnish blue print plans and specifications in accordance with our SPECIAL PLAN offer on page 70.

Prices on any of these barns delivered at your station will be cheerfully quoted on request. In asking for quotations, please state size of barn, design number, height of studs and floor plan number. If changes are desired in floor plan, send a rough pencil sketch showing arrangement and size of stalls, etc.

Our delivered prices will always include guaranteed sufficient quantities of all necessary lumber, shingles, finish and barn sash to complete the barn in accordance with our blue print plans and specifications, excepting plank flooring for stalls. If plank flooring is wanted, please so advise, and a separate price will be quoted on same. Specification of material we furnish for these barns will be found on pages 69 and 70.

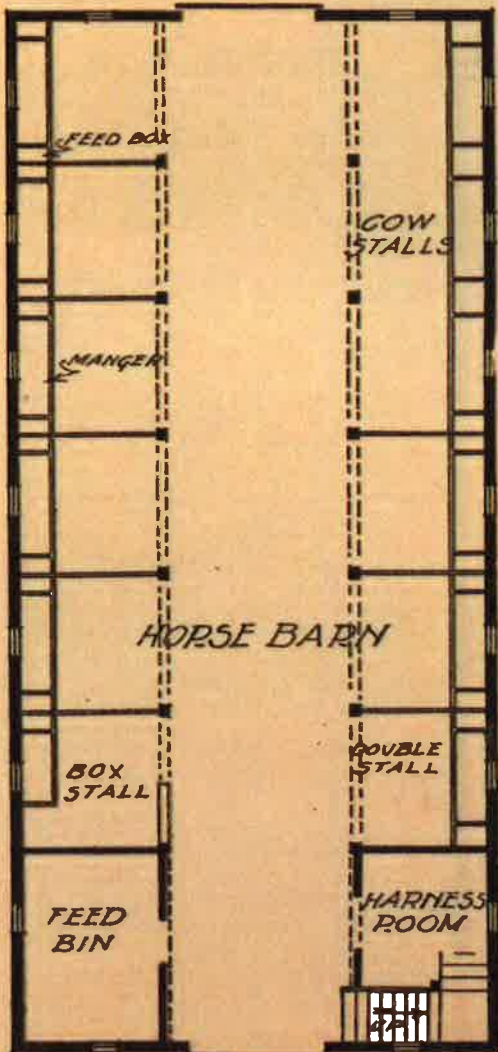

Floor Plan No. 180

Width	Length	Height of Studs	Floor Plan
28	40	14 ft.	No. 180
28	50	14 ft.	No. 180
28	60	14 ft.	No. 180
28	70	14 ft.	No. 180
30	40	14 ft.	No. 180
30	50	14 ft.	No. 180
30	60	14 ft.	No. 180
30	70	14 ft.	No. 180
50	100	16 ft.	No. 200

Floor plan No. 200 will be found on page 75.

PLANS COMPLETE for barn of this design in any of the sizes listed on this page. **\$3.00**
Read page 70 explaining how to get these plans free.

Prices on complete hardware and paint for any of the barns listed on this page will be quoted on request.

CONTRACTORS LUMBER SUPPLY COMPANY, SEATTLE, WASH.

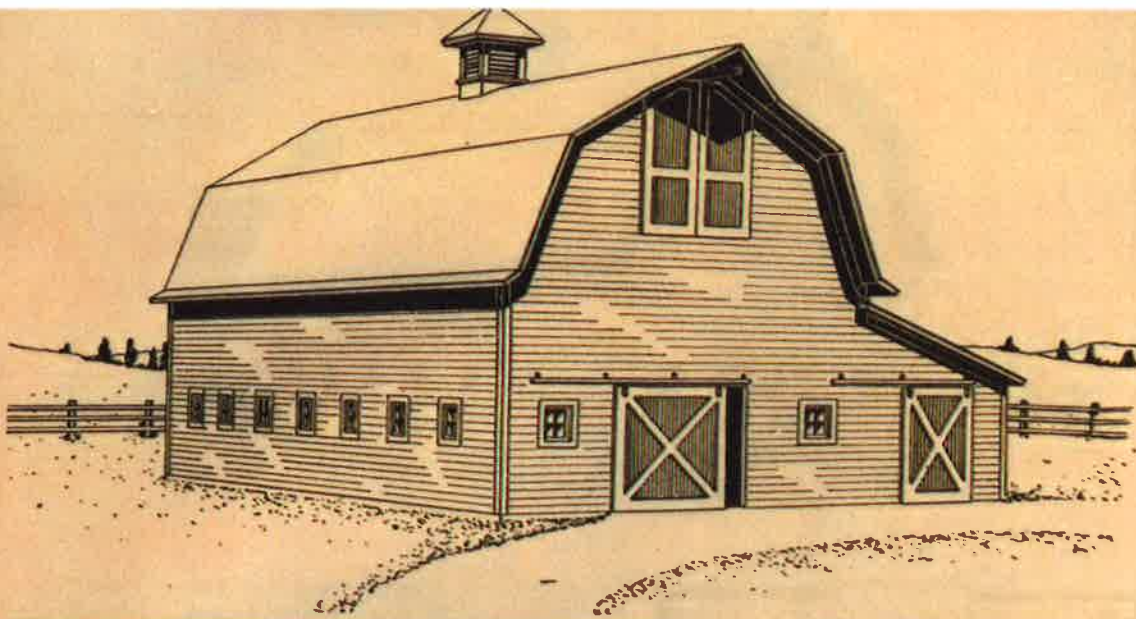

Barn Design No. 185

The main barn shown above is of the same general plan as our design No. 180 shown on preceding page, with a 12 ft. lean-to added. The lean-to provides a commodious cow shed at little additional expense. This is one of the most economical barns that can be built. Any number of slight changes may be made in the floor plan, without increasing the cost.

Below you will find a list of stock sizes for which blue print plans and specifications can be furnished by return mail. For sizes other than shown below, we will furnish blue print plans and specifications in accordance with our

SPECIAL PLAN offer on page 70.

Prices on any of these barns delivered at your station will be cheerfully quoted on request. In asking for quotations, please state size of barn, design number, height of studs and floor plan number. If changes are desired in floor plan, send a rough pencil sketch showing arrangement and size of stalls, etc.

Our delivered prices will always include guaranteed sufficient quantities of all necessary lumber, shingles, finish and barn sash to complete the barn in accordance with our blue print plans and specifications, excepting plank flooring for stalls. If plank flooring is wanted, please so advise and a separate price will be quoted on same. Specifications of materials we furnish for these barns will be found on pages 69 and 70.

Width	Length	Height of Studs
40	40	14 ft.
40	50	14 ft.
40	60	14 ft.
40	70	14 ft.
42	40	14 ft.
42	50	14 ft.
42	60	14 ft.
42	70	14 ft.

PLANS COMPLETE for barns of this design in any of the sizes listed on this page. **\$3.00**
Read page 70 explaining how to get these plans free.

Prices on complete hardware and paint for any of the barns listed on this page will be quoted on request.

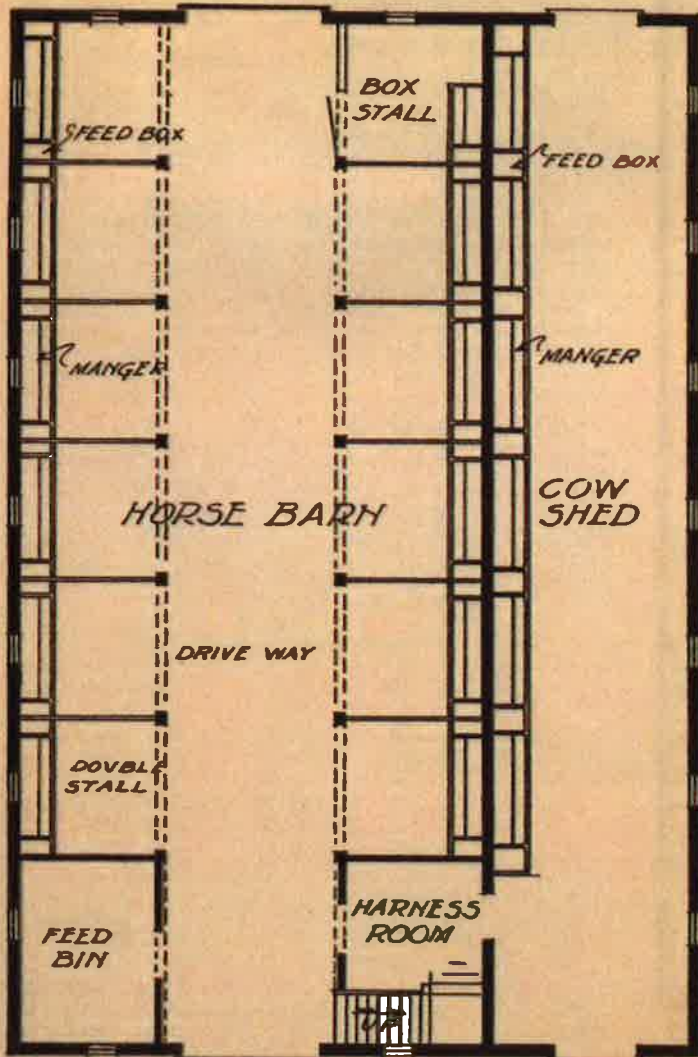

Floor Plan No. 185

CONTRACTORS LUMBER SUPPLY COMPANY, SEATTLE, WASH.

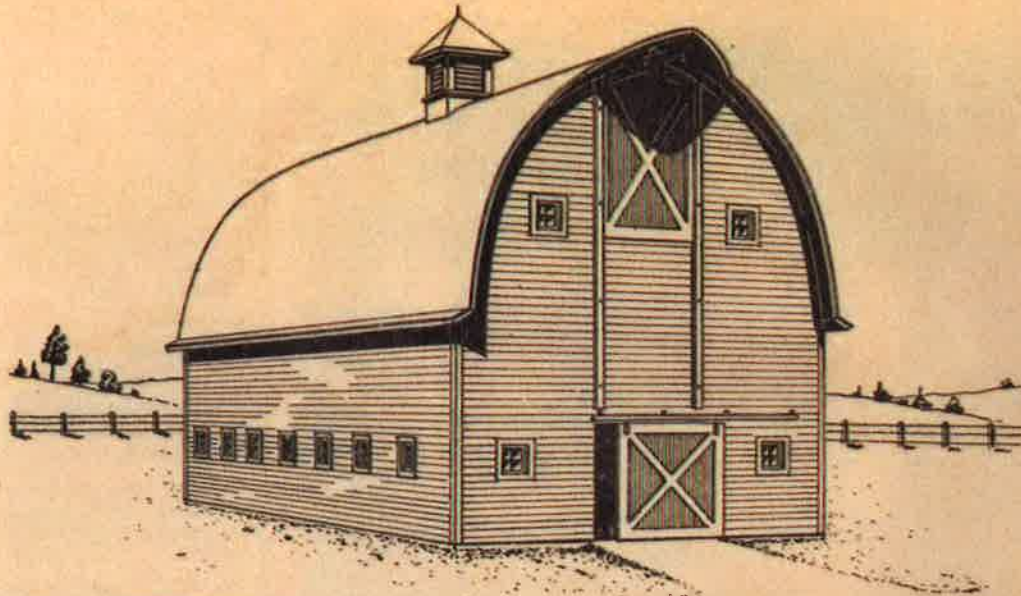

Barn Design No. 210

This Gothic type of barn roof is a slight variation from, and we believe an improvement over our circle roof design No. 200, shown on page 75, which proved so popular last year. The Gothic roof provides for increased mow space free from obstructing supports of any kind.

Experience has shown that this type of roof possesses greater wind resisting qualities and is therefore less liable to damage from high winds than any kind of roof heretofore designed. We are advised by a customer in North Dakota to whom we sold a barn of this type last year, that in a recent cyclone which traversed his part of the state, not one barn with a Gothic or circle roof was destroyed, while dozens of barns with the old style roofs were utterly demolished.

Floor plan shown is merely suggested as a practical and convenient arrangement for a horse barn. This plan may be modified to suit special needs without materially adding to cost.

Prices on barn of this design in any size delivered at your station will be cheerfully quoted on request. In asking for quotations please state size of barn wanted, and if change is wanted in floor plan, send us a pencil sketch of your requirements.

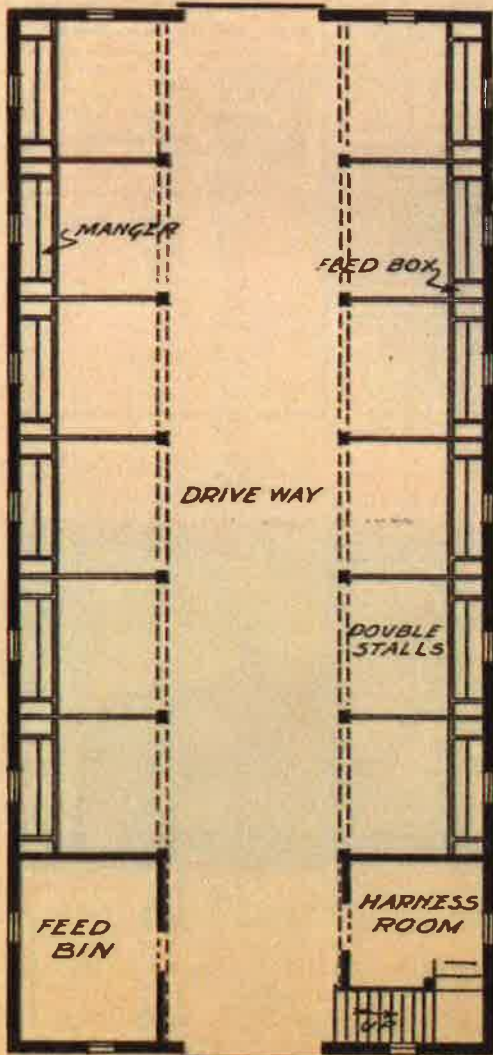

Floor Plan No. 210

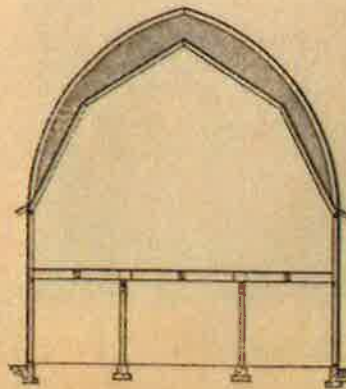



In above section the shaded part shows additional mow space in this type of roof as compared with Gambrel roof.

PLANS COMPLETE for barn of this design in any of stock sizes listed on page 71. **\$3.00**

Other sizes furnished in accordance with our SPECIAL BARN PLAN offer on page 70. Free plan offer on page 70.

CONTRACTORS LUMBER SUPPLY COMPANY, SEATTLE, WASH.



NORTH PARK TIMBER CO.
 RENDSORN CAPITAL
 MANUFACTURING AND LUMBER BUSINESS
 J. H. DICKENS

HORSFORD RANCH
 J. H. DICKENS

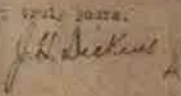

WALDEN, OREGON

MAY 28, 1919

My dear Mr. Anderson:
 I am glad to hear that you are
 satisfied with the barn which you built May 1918 and 1919.
 The barn has been perfectly satisfactory
 in every way. It is 30 x 50 feet with twenty-four
 stalls on one side for horses and the cow barn and
 stalls that on the other side. It holds 100 tons
 of hay, has a self supporting roof, the abutment
 is nearly flat and have given no trouble.
 You will obtain more detailed information
 about this barn from the Contractors Lumber Supply
 Company of Seattle, Washington, from whom I bought
 the material to build it. I would be glad to give
 you any definite specifications, but they are at
 the ranch, and I do not remember the details of
 construction.
 Trusting the above information may be of
 assistance to you, I am
 Very truly yours,

Walden, Oreg.,
 June 28, 1919.

Contractors Lbr. Sup. Co.
 Seattle, Wash.

Gentlemen:

Regarding your letter of
 June 17th, wish to state
 that you may see my letter
 to L. W. Baker & Sons, of
 May 24th in your 1920 cat-
 alogue.

I might add that my barn
 has been entirely satisfac-
 tory, and I think it the only
 barn for this country.

It is very much out of the
 ordinary, both in appear-
 ance and in hay capacity.
 I have had a great many
 compliments on same from
 ranchmen from all parts of
 the country, and I think it
 quite an advertisement in
 itself.

Yours very truly,
 J. H. DICKENS.



Circle roof barn of Mr. N. V. Anderson, Cowles, Nebraska, under construction.



Circle roof barn of Mr. J. P. Walde, Warwick, North Dakota.

We show above photograph reproductions of circle roof barns built by our customers from plans
 and material supplied by us. The circle roof and Gothic roof is the latest thing in barn construction.
 The rafters (or bents) are furnished by us hand sawed to proper radius.

CONTRACTORS LUMBER SUPPLY COMPANY, SEATTLE, WASH.

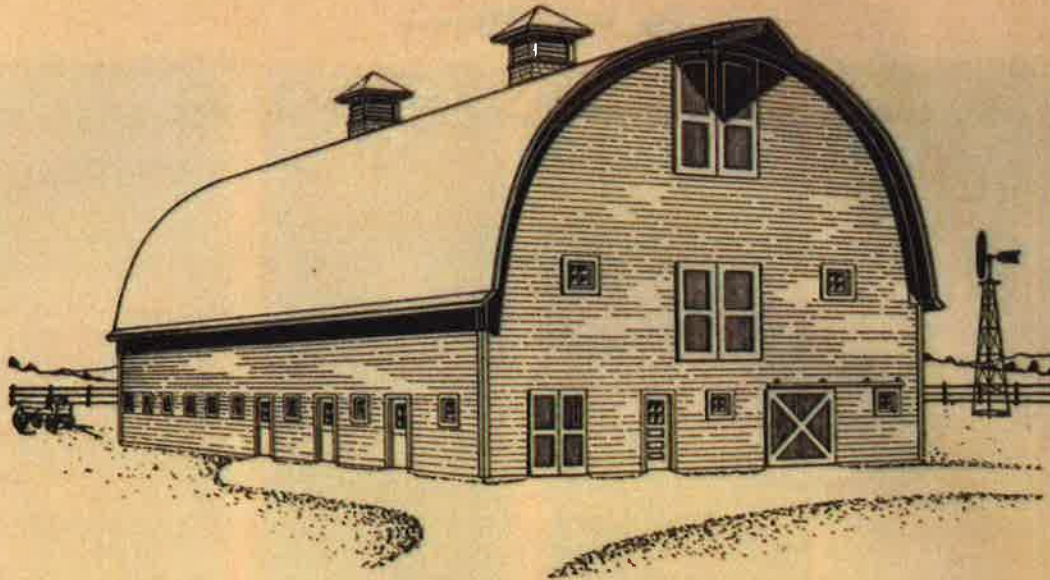

Barn Design No. 200

Width	Length	Height of Studs	Floor Plan
30	60	14 ft.	No. 180
50	100	14 ft.	No. 200

Write for prices delivered at your station.

A great many farmers who have built this design with our material have told us that it is by far the most attractive and most practical barn that can be built. The only reason why there are fewer of these barns built than the other designs shown is because the construction of the roof is not understood. It is thought to be very difficult and expensive. This is not the case. The construction is very simple and is fully explained and shown in our complete working blue print plans and specifications which are free to our customers.

There is no tendency for the roof to spread necessitating the use of heavy trusses since the bearing is directly down upon the studs. The mow of this barn is all space and the noticeable feature is the absence of trusses.

The roof is shingled over its entire surface. Rubber roofing is supplied to extend well down on the sloping sides.

This plan as shown is 50 feet by 100 feet and has stall space for 38 horses, not including the two box stalls. If the machine or tool room is not needed the partition may be omitted, making room for 22 cows.

This style of roof is a decided favorite among our customers. The extra cost of material over the Gambrel roof is very slight and we know it to be a fact that contractors who understand our proposition of milling the rafters at our mills have offered to build the larger sizes for as much as \$40.00 less than a barn of the same size with the Gambrel roof.

There is lots of light and plenty of ventilation. The side doors to cow shed are specially made dutch doors so that the top half may be opened and the bottom left closed.

Any number of slight changes may be made in the floor plan, without increasing the cost.

We guarantee to furnish all lumber, shingles, rubber roofing and millwork in sufficient quantities to complete each barn according to our plans and specifications, except plank flooring for stalls, which is extra. Price on plank flooring will be quoted on request. Complete specifications of all material we furnish for these barns will be found on pages 69 and 70.

PLANS COMPLETE for barns of this design **\$3.00**
in any of the sizes on this page.
Read page 70 explaining how to get these plans free.

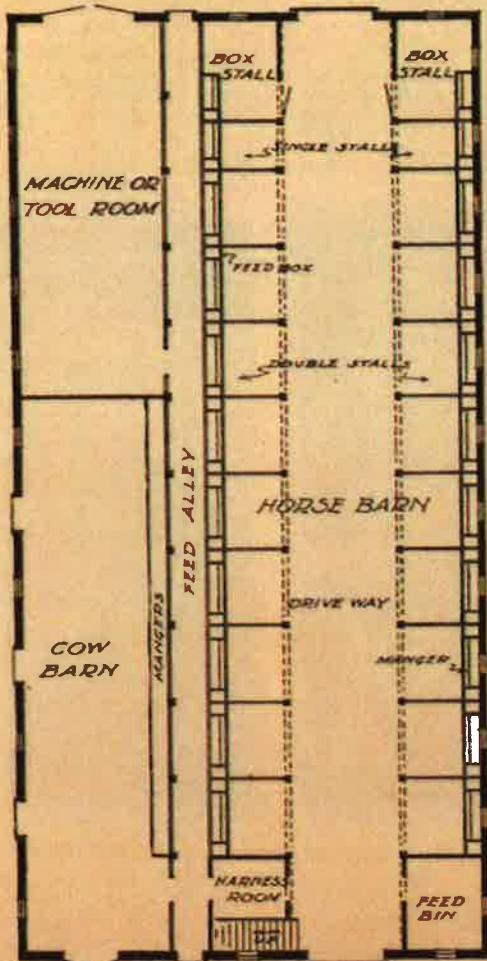

Floor Plan No. 200

Prices on complete hardware and paint for any of the barns listed on this page will be quoted on request.

CONTRACTORS LUMBER SUPPLY COMPANY, SEATTLE, WASH.